

AGENDA
CHERRY COUNTY BOARD OF COMMISSIONERS
Cherry County Courthouse, Commissioners Meeting Room
Tuesday, January 30, 2024 @10:00a.m.

1. Call Meeting to Order, Roll Call, Open Meetings Act Announcement, and Pledge of Allegiance
2. Discuss/Act – Approve Minutes
3. Discuss/Act – Approve Claims
4. New Business

- a. Cherry County Roads Update
- b. Discuss/Act – Request to Occupy County Right-of-Way
- c. Cherry County Emergency Management Update
- d. Cherry County Noxious Weed Control Update
- e. Cherry County South Building Update
- f. Discuss/Act – Reschedule May 14, 2024 Board of Commissioners Meeting
- g. Discuss/Act – Cherry County Planning Commission Appointment(s)
- h. Discuss/Act – Cherry County Visitor Promotion Board Appointment(s)
- i. Discuss/Act – Set Time & Date for Public Hearing re: Sale of the Following
Described Real Estate, to wit: That part of the SE1/4NE1/4 of Section 7, Township 34, North,
Rage 33, West of the 6th P.M., Cherry County, Nebraska, described as follows: Beginning at a
point 205 ft North of the NE corner of the NW1/4SE1/4 of said Section 7, thence East 150 ft,
thence North 300 ft, thence Southwest to a point 100 ft North of the point of beginning, thence
South to said point of beginning (400 block of N Cherry St, Cody, NE)
- j. 11:30 a.m. Discuss/Act – Approve Cherry County Extension Board Candidate List(s)
- k. Discuss/Act – Approve Cherry County Extension Board By-Laws
- l. Discuss/Act – Cherry County Extension Board Appointment(s)
- m. Review Cherry County Extension Annual Report
- n. 1:00 p.m. Public Comment
- o. 1:15 p.m. **Board of Equalization**
 1. _____
- p. 1:30 p.m. **Board of Corrections**
 1. Staff & Census Update
- q. 2:00 p.m. Conduct Cherry County Emergency Management Director Interviews
- r. Discuss/Act – Cherry County Emergency Management Director Position

5. Adjournment

This is an open meeting of the Cherry County Board of Commissioners. Cherry County abides by the Nebraska Open Meetings Act in conducting business. If necessary, Cherry County reserves the right to adjust the order of items on the agenda and to modify the agenda to include items of an emergency nature. The agenda shall be kept continually current and is available for public inspection at the Cherry County Clerk's Office during normal business hours.

Job:23177399

CHERRY COUNTY
REQUEST TO OCCUPY COUNTY RIGHT-OF-WAY

Telcom Construction for Lumen (Century Link), hereinafter referred to as "Owner", request to construct a/an
Buried Service Wire occupying the Cherry County public highway system at (legal)
description Push 50 feet of 1s fiber thru conduit from MST to customer's property and continue on customer's property

The Owner proposes to place and maintain the aforesaid construction on Cherry County Public Right-of-Way at Owner's risk and expense and hereby absolves Cherry County, its' officials and employees from any liability arising from the placing and maintaining of said construction. Cherry County will not be liable for any damage to the aforesaid construction that may be caused by Cherry County during maintenance of the right-of-way and if a future road improvement project is scheduled through this area and if the aforesaid construction conflicts with the road improvement project, the Owner will relocate the aforesaid construction at the Owner's expense.

The item that is crossing the roadway and that will occupy the County Right-of-Way is recommended to be bored under the roadway. It is recommended the holes dug for the boring process should be located on private right-of-way. Open trench may be allowed at the discretion of the County. The Owner will cooperate fully with the officials of Cherry County and will keep them fully and immediately informed of all construction or maintenance work required on the Cherry County Public Right-of-Way. The new aforesaid construction shall be placed at least four foot below the present flow line of both adjoining ditches. The surface of the roadway and the road ditch will be restored to the same condition as it was prior to the work and such restoration will be accomplished to the reasonable satisfaction of Cherry County Officials.

The person to be contacted, PRIOR TO CONSTRUCTION by anyone needing a permit, is the County Highway Superintendent, PO Box 50, Valentine NE 69201. 402-376-2691.

Each location is to be inspected by the Cherry County Roads Department when the permit is submitted and upon project completion, at which latter time any work or supply of gravel reasonably required to restore the surface of the roadway or work to restore the county Right-of-Way to the same condition as it was prior to the work will be determined and the work performed and gravel supplied by Owner.

A plat map and sketch indicating approximate location to or from some easily recognizable landmark must be attached. GPS coordinates are recommended.

The Owner/Applicant shall be responsible for calling Diggers Hotline at 1-800-331-5666, and having utilities located before beginning any work. The Owner/Applicant will be responsible for all damages to any utilities.

The Owner/Applicant shall be responsible to furnish signs, barricades and/or flag persons and whatever is necessary to protect the traveling public from exposure to accidents.

1/2/24
Date

Jane Brown
(Signature of Owner)
PO Box 189, Clearwater, MN 55320
(Complete Mailing Address)

PERMIT

At the option of the County Board of Commissioners, the owner shall furnish a Surety Bond for an amount specified by the County Board of Commissioners. The form of the Surety Bonds shall be acceptable the the Cherry County Board.
Surety Bond Required: Yes _____ No X Amount _____

COMMENTS: (County only) I have reviewed the plans and specifications for this project and recommend that this permit be granted subject to the Owner agreeing to all of the terms listed above.

1-08-24
Date

[Signature]
Signature - Highway Superintendent

We hereby grant permission to occupy the County Right-of-Way at the location and according to the procedures and conditions described in this document. This permit is valid for 6 months from date of issue.

Date

Signature - Board Chairman

Cherry County Road Department
Application Requesting Permission To Bury Utilities
In Or On County Right-Of-Way

I, Telcom Construction for Lumen / Century Link request permission from the Buried Service Wire County Commissioners
to bury or locate Lumen (Century Link) in or on the right-of-way of the County of Cherry
Name of Utilities

Location 88130 Simeon RD

Describe by $\frac{1}{4}$ section the location where the utility is to be located

Length 50 feet

Estimate the length of the proposed utility on County right-of-way.

Draw sketch on plat below showing location of such Utility:
Township _____ Range _____ of 6th P.M. _____ County _____

6	5	4	3	2	1
7	8	9	10	11	12
18	17	16	15	14	13
19	20	21	22	23	24
30	29	28	27	26	25
31	32	33	34	35	36

Owners or renters desiring to place waterline or gas line in or across County right-of-way must have permission granted by the _____ County Commissioners. Water and gas lines buried in the ROW or under the roadbed proper must be a minimum of 48" deep and be of steel, copper, or approved PVC pipe. All electric service that is buried must be buried to the following depths, primary 48", secondary 36". All telephone communications minimum of 30". In case any of the foregoing services are disrupted, damaged or put out of service, the County will not be liable in any way. Permission must be granted by the _____ County Commissioners for any installation of utilities. An approved sign shall be erected on a post 5' above ground level designating the route and location of the utility.

Approved _____ Rejected _____

1/2/24

Dated

Jane Brown

Name of Applicant

Date

Chairman

Bow + Arrow w

R 30 & 29 W

JOINS MAP 8

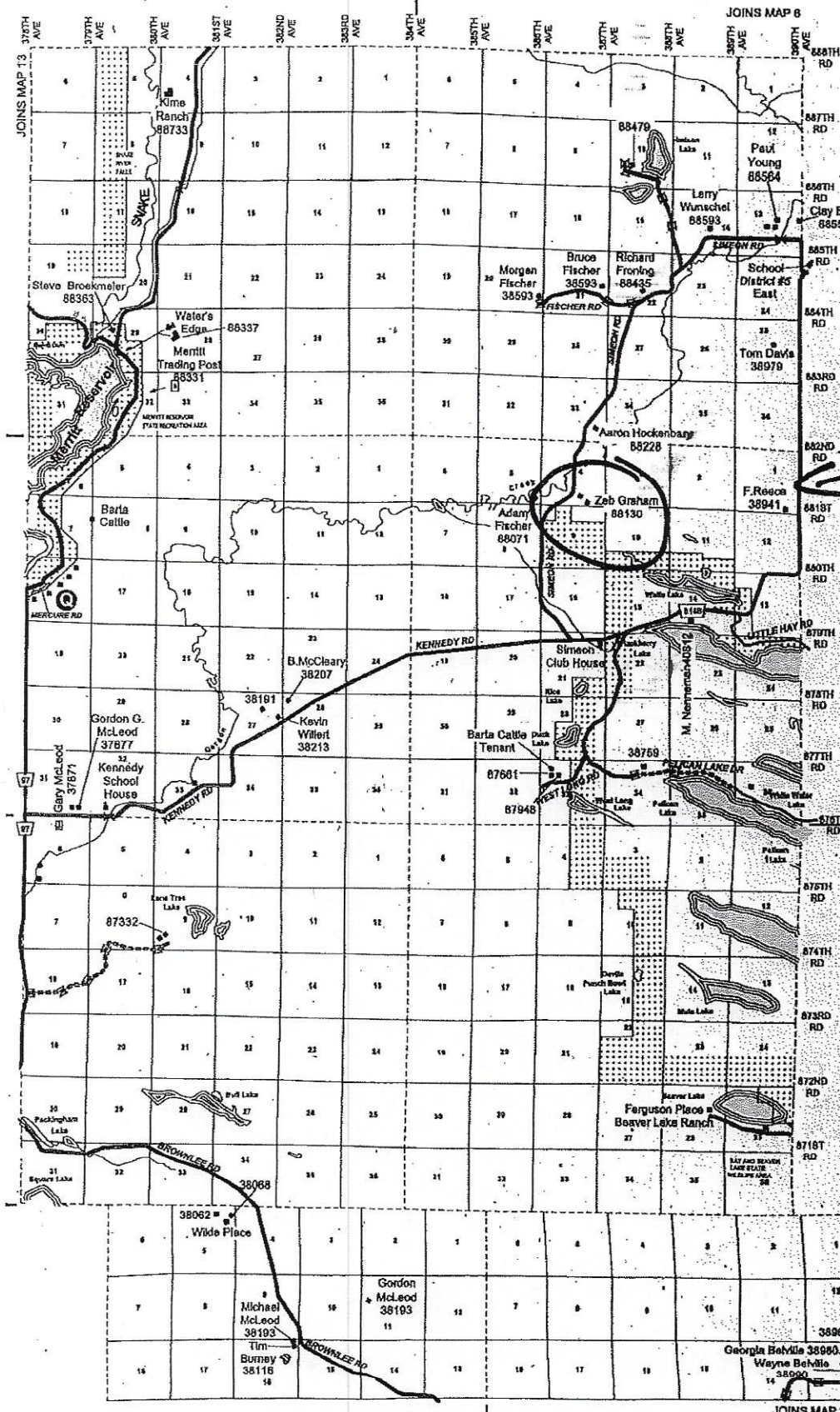

Parcel
#16025559
Section 4
Town-30
Range-29W

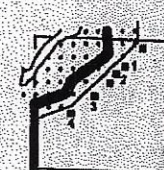

- Q**
1. Clint Burney - 37825
2. 37831
3. 37819
4. W. Hitchcock - 37813

1	2	3	4	5	6	7	8
9	10	11	12	13	14	15	16
17	18	19	20	21	22	23	24

Cherry County Clerk

From: Cherry County Visitor Promotion Board
Sent: Friday, January 12, 2024 1:51 PM
To: Cherry County Clerk
Cc: Nina Nelson; Martin Denaeyer; Mike McConaughy
Subject: CCTPB position renewals 2024

Follow Up Flag: Follow up
Flag Status: Flagged

Brittny,

If there is space on the 1/30/24 agenda, the Cherry County Tourism Promotion Board would like an item added

Subject: Official Request for Approval of Board Members' Renewal

Dear Cherry County Commissioners,

The Cherry County Tourism Promotion Board formally requests the approval of Sara Ferguson and Rich Mercure for the extension of their seat on the Cherry County Tourism Board for an additional 4-year term. Both individuals have expressed their desire to continue their service, and the minutes from our latest CCTPB meeting on 1/2/24 document their renewal request and subsequent board approval.

Should it be necessary for your vote, we kindly ask that you consider the request for the extension of Sara Ferguson and Rich Mercure's renewal on the Cherry County Tourism Board at your upcoming board meeting scheduled for 1/30/24 or next available meeting. We seek your favorable vote for approval.

Thank you for your attention to this matter.

Sincerely,

Regina Osburn / Cherry County Tourism Director

Regina Osburn

Cherry County Tourism Director

Phone: 402-376-2969

email: tourism@cherrycountyne.com

Memorandum

To: Cherry County Commissioners

From: Jay Jenkins, Engagement Zone Coordinator
Michelle Garwood, Educator, 4-H Youth Educator
& Ryan Benjamin, Educator, Livestock Systems

CC: Brittney Petersen, Cherry County Clerk

Date: January 25, 2024

Re: Cherry County Extension Board Positions

This is the list of people from which the Extension Board would like to make its recommendation for filling the current Extension Board vacancies. Jay Danielski, from the Valentine area, and Angie Lincoln, formerly of the Cody-Kilgore area, have both served the maximum number of consecutive terms.

Jerry Sharp
Janett Sharp
Monty Neiffer
Ann Neiffer
Amber Daugherty

If acceptable, the Extension Board will recommend the individuals above to you for filling Jay's vacant position.

Ryan Sexson
Adam Johnson

If acceptable, the Extension Board will recommend the individuals above to you for filling Angie's vacant position.

Laura Willert

Laura has agreed and was approved by 4-H Council to serve again in 2024 as the 4-H Council Representative to Extension Board.

CONSTITUTION

Art. I: Name

The name of this organization shall be Nebraska Extension in Cherry County.

Art. II: Purpose

The purpose of this organization shall be to establish, maintain, and provide direction to the Nebraska Extension Program in Cherry County, Nebraska, in order to aid in diffusing among the people of such county, useful and practical information on priority issues identified by the executive board (here in after referred to as the "Extension Board"), Program participants of the County Extension organization, county residents and Nebraska Extension, and further, to encourage the application of such information. The Program shall be carried on in each county or group of counties under the direction of the Extension Board of the Extension organization of the county in such manner as may be mutually agreed upon by the County Board and the Extension Board of such county or counties provided for in Neb. Rev. Stat. §2-1602, as amended, and the Regents of the University of Nebraska, through their duly appointed Extension representatives. The Extension Board is a unit of the county government and shall be granted such powers and authority as bestowed upon it by the county.

Art. III: Scope

The Nebraska Extension Program, a collaborative effort of federal, state, and county governments, conducts Programs in priority issue areas that include Livestock Systems, Water and Cropping Systems, Agricultural Profitability, 4-H Youth Development, Food Nutrition and Health, Horticulture Landscape and Environmental Systems, Rural Prosperity Nebraska, and Early Childhood; which have been identified by the Extension Board, Program participants of the County Extension organization, county residents, and Nebraska Extension, which also facilitates Extension engagement Programs with other appropriate units of the University as deemed necessary.

Art. IV: Participation

The Programs shall be widely available to people residing in the county. No one's participation in the Extension Programs shall be illegally discriminated against based upon race, color, ethnicity, national origin, sex, pregnancy, sexual orientation, gender identity, religion, disability, age, genetic information, veteran status, marital status, and/or political affiliation. Extension shall comply with all applicable federal, state, and local non-discrimination laws. In order to ensure that the residents of the county are offered the opportunity to participate in the planning and operations related to the activities of Extension, the Extension Board meetings shall be conducted in conformity with Neb. Rev. Stat. §§84-1407 through 84-1414, as amended, and any other applicable Public Meetings Laws.

Art. V: Extension Board

Section A. Extension Board

The governing power of the organization shall be vested in an Extension Board, the members of which shall be selected in a manner and to be representative of the county, as delineated in this Constitution, the Bylaws, and a written interlocal agreement between the County Board and the Board of Regents of the University of Nebraska.

Section B. Officers and Responsibilities

At the first meeting after January 1 each year, the Extension Board shall choose from its members by a majority vote, a President, a Vice-President, a Secretary-Treasurer, and other ad-hoc positions as needed. Officers shall serve until their successors are selected, qualified, and installed.

The duties of the officers shall be such as defined in the Bylaws.

Section C. Duties

The responsibilities of the Extension Board will be to determine Extension Program goals, objectives and needs.

In order to facilitate such development, the Extension Board shall:

1. Programming
 - a) Evaluate the Program's ability to meet objectives and engage in strategic planning in order to facilitate improvements.
 - b) Convene appropriate Program Advisory Committees to establish and support Extension Program direction.
 - c) Where appropriate, engage in collaborative efforts with the Extension boards of other County Extension organizations, in order to more efficiently and effectively meet those Program needs that cross over more than one Extension organization's geographic boundaries.

2. Property and Resource Management
 - a) Provide facilities adequate to accomplish Program objectives.
 - b) After carefully considering the input of Nebraska Extension, and County Board guidance, and in collaboration with the Lead Extension Educator and Engagement Zone Coordinator, develop and approve an annual Program budget realistically designed to accomplish the goals of the Program and submit a request to the County Board to fund the budget, in accordance with state statutory requirements and the requirements of the County Board relating to timely budget requests.
 - c) Monitor, and/or approve claims with the budget following approval of said budget by the County Board. Prior to the Extension Board's application for grant funds or other similar kinds of restricted gifts, the Extension Board will fully inform Nebraska Extension of the grant and its applications. Prior to submitting any such grant application, Nebraska Extension and the Extension Board will mutually agree upon the use and administration of the funds.
 - d) As required by Neb. Rev. Stat. §§2-1606 and 2-1607, R.R.S., file with the county clerk of the County on or before January 1 of each year (1) a report of Program work during the preceding year; (2) a sworn itemized statement of expenditure during the preceding year, and (3) a budget or estimate of funds necessary for the carrying on of such work during the ensuing year. Such report shall also be provided at the same time to Nebraska Extension.
 - e) Submit such reports as requested or required by the County Board, Nebraska Extension, the National Institute of Food and Agriculture, and the United States Department of Agriculture.
 - f) Provide as requested Program reports to the County Board relative to the accomplishments of the Extension Program in the region.
3. Personnel
 - a) Provide office support staff and County funded Extension Assistants, in numbers and qualifications commensurate with the realistic needs of the Program, after careful consideration of the recommendations and input of Nebraska Extension.
 - b) Work collaboratively with and provide advice and direction to the Lead Extension Educator (i.e. University of Nebraska- Lincoln employee appointed to oversee daily operations) in the areas of budget, personnel and programming.
 - c) Provide Nebraska Extension with feedback or input regarding the hiring, termination and performance of its employees (i.e. Extension Educators and Extension Assistants) providing services to the County Extension Program. The Extension Board may participate in any interview process associated with the appointment of a new Extension Educator or Extension Assistant in its Program, in order to provide meaningful input to Nebraska Extension.

An Executive Committee will be the elected officers of the Board approved to perform duties delegated by the Extension Board.

Art. VI: Meetings

The Extension Board shall meet at least four (4) times a year. In the months that the Board does not meet, the officers (or Executive Committee) shall meet to transact that business for which they (or it) have (has) authority to transact. These meetings shall be held at a time and place to be determined by the Extension Board.

A special meeting of the Extension Board may be called as needed by the President or by written notice signed by four (4) members of the Extension Board. This written notice may be in an electronic format, but any decision or discussion of the special meeting topic in advance of or at this special meeting must take place at a public meeting, publicized in advance. All Extension Board meetings shall be conducted in conformity with Neb. Rev. Stat. §§84-1407 through 84-1414, as amended, and any other applicable Public Meetings Laws.

Art. VII: Notice of Meetings

All Extension Board meetings shall be conducted in conformity with Neb. Rev. Stat. §§84-1407 through 84-1414, as amended, and any other applicable Public Meetings Laws, including the required publication of the meeting time, place, and agenda. Except as otherwise provided by law, the minutes of the meetings, kept by the secretary or other designee, shall be a public record open to inspection by the public upon request during normal business hours.

Art. VIII: Quorum

Four (4) Extension Board members shall constitute a quorum for transacting business at all regular and special Extension Board meetings. Members of the Extension Board shall be entitled to one vote per member on any action put to vote. A vote carrying a majority of a quorum shall be deemed the action of the Extension Board.

Art. IX: Location of Extension Office

The office of Cherry County Extension shall be located at Valentine, Nebraska.

Art. X: Amendments

This Constitution may be amended at any regular or special meeting of the Extension Board, by a favorable vote of two-thirds of the total Extension Board membership, with consultation and approval of Nebraska Extension Administration.

BYLAWS

Art. I: Extension Board

Section A. Membership

The County Board by resolution will adopt the number of Extension Board members. The Extension Board will be composed of seven (7) registered voters in the county, appointed by the County Board to assure equitable representation of the organization's population.

Section B. Candidates for Appointment

Interested potential candidates will be identified through an open nomination process, as specified in a written interlocal agreement between the County Board and the Board of Regents of the University of Nebraska.

Section C. Term of Service

All terms of service shall begin on January 1 of each year. All persons serving as officers or members of the Extension Board shall continue to serve until a successor is appointed and accepts the position. All persons appointed shall serve three-year terms. In order that some continuity within the Extension Board is preserved, staggered appointments should be used. No person shall serve more than two consecutive terms.

Section D. Vacancies

In the event a vacancy on the Extension Board exists because of death, resignation, incapacity, relocation outside of the region the member was appointed to represent, or other reason, the County Board shall appoint a replacement to fill the unexpired term. At any time, the County Board may remove a member of the Extension Board, if it determines that the member's participation or lack of participation is not in the best interest of the Extension Program.

Section E. Compensation

Extension Board members may receive compensation established by the County Board for the public service they provide. They may be reimbursed for mileage at the rate deemed permissible by the County Board.

Art. II: Duties of Officers

Section A. President

The president of the organization shall:

1. provide overall leadership of the Extension Board in relation to programming, finances, and operations of the County Extension organization.
2. act as official liaison for the Extension Board between the County Extension organization, the County Board, and the University of Nebraska Board of Regents through its assigned representative.
3. serve as presiding officer for all meetings of the organization.
4. identify and appoint Program Advisory Committees.
5. performs such other functions as are assigned by the Extension Board.

As required by Neb. Rev. Stat. §§2-1606 and 2-1607, as amended, the president shall join the secretary in filing with the county clerk of the County on or before January 1 of each year (1) a report of Program work during the preceding year; (2) a sworn itemized statement of expenditures during the preceding year, and (3) a budget or estimate of funds necessary for the carrying on of such work during the ensuing year.

Section B. Vice-President

The vice-president shall assume the duties of the president in the absence of the president and perform such other functions as are assigned by the Extension Board.

Section C. Secretary-Treasurer

The secretary of the organization shall keep on file in the Nebraska Extension Office in Cherry County, copies of all minutes and any written agreement (contracts, grants, etc.) entered into by the Extension Board, send copies of such agreement to the County Board and Engagement Zone Coordinator, and perform such other functions as are assigned by the Extension Board. As required by Neb. Rev. Stat. §§2-1606 and 2-1607, as amended, the secretary shall join the president in filing with the county clerk of the County on or before January 1 of each year (1) a report of Program work during the preceding year; (2) a sworn itemized statement of expenditures during the preceding year, and (3) a budget or estimate of funds necessary for the carrying on of such work during the ensuing year. Such report shall also be provided at the same time to the Nebraska Extension Dean and Director.

The treasurer shall report to the Extension Board at each regular meeting, the financial standing of the organization. A financial report of all county funds shall be prepared annually for submission to the County Board and to the Dean and Director, Extension Division, Institute of Agriculture and Natural Resources, University of Nebraska - Lincoln.

Art. III: Committees

The president, with the approval of the Extension Board, may appoint persons to the following committees:

Program Advisory Committee
Nomination Committee
Budget Committee
Others as needed

Program Advisory Committees shall be an integral part of the Extension Program's planning process. Program Advisory Committees shall consist of individuals in the County or the region for the purposes of providing the Extension Board with specific advice, planning and evaluation of Extension Program needs, and to assist in identifying resources necessary to facilitate programming. Persons having specific interests or skills relating to Program needs should be included on the Program Advisory Committee whenever possible. Program Advisory Committees shall provide regular progress reports to the Extension Board through a representative or staff member or as otherwise directed by the Extension Board. Family and Community Education Councils and 4-H Councils may also serve as Advisory Committees.

A Nomination Committee selected by the Extension Board from current Extension Board members and other citizens of the county will coordinate the nomination process and make recommendations to the County Board. The County Board will announce the opportunity to serve by providing notice of any vacancies. The Extension Board shall complete its nomination process by November 15 of each year, and the appointments shall be made by the County Board no later than the last scheduled County Board meeting of the calendar year. In making its recommendations, the Extension Board shall consider the following criteria for balance in representation: geographic location, program interest, leadership potential, possession of specifically needed skills, and cultural diversity (e.g. gender, race).

The Budget Committee shall make budget recommendations, and with the assistance of the Lead Extension Educator, or their designee, prepare an annual budget for presentation to the County Board, as required herein.

Art. IV: Order of Business

1. At regular meetings of the Extension Board, the following recommended order of business should be observed. A consent agenda item may be used for routine, procedural, informational, and self-explanatory non-controversial items typically found in an agenda.

- Call to order

- Roll call
- Approve minutes of previous meetings
- Secretary's report
- Treasurer's report
- President's report
- Committee reports
- Extension faculty and staff reports (including EZC reports)
- Program advisory reports
- Budget and communications
- Unfinished business
- New business, including planning for Program priorities
- Other business
- Adjournment

Art. V: Parliamentary Authority

Robert's Rules of Order shall be the authority in matters not covered by the constitution or bylaws.

Art. VI: Amendments

These Bylaws may be amended at any regular or special meeting of the Extension Board, by a favorable vote of two-thirds of the total Extension Board membership with consultation and approval of Nebraska Extension Administration.

This Constitution and these Bylaws were adopted at a meeting of the Cherry County Extension Board held on _____, 2023.

Approval Signatures:

For the Extension Board

Date

For the County Board

Date

Dean and Director,
Nebraska Extension

Date

October 18, 2023

January 2024

Cherry County Board of Commissioners/Supervisors
365 N Main St.
Valentine, NE 69201

Dear Commissioners,

Nebraska Extension is pleased to continue a strong tradition of making a difference in the lives of individuals, families, businesses and communities in Cherry County! Our programs address issues that Nebraskans have identified as being important to them.

Enclosed you will find local Extension programming and financial summaries for 2023. Specific items include 1) Summary of 2022-23 budget expenditures, 2) Current fiscal year 2023-24 budget, 3) County Impact Report, 4) Program impacts and accomplishments for each educator and assistant/associate, Individual Impact Statement(s), and 6) Samples of 4-H newsletters, Extension newsletters, major program brochures, and other products that represent 2023 programming.

Thank you for continuing to invest in Nebraska Extension as a local collaborative partner. We strive to be great stewards of resources and work hard every day to demonstrate a strong return on your investment. As you know, Extension educators and assistants live, work and engage with people in your local and area communities. We look forward to making a difference in the lives of Nebraskans together with you!

Sincerely,



Ed Heinert
President
Cherry County Extension Board

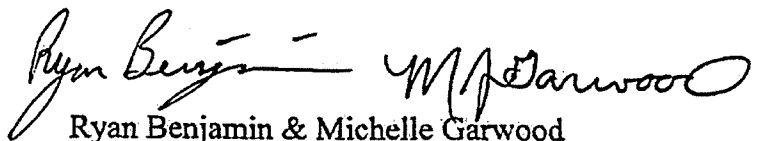

Ryan Benjamin & Michelle Garwood
Lead Educators
Nebraska Extension in Cherry County

Enclosure

CHERRY COUNTY GENERAL					Fund	Code	Description
					Function	0100	GENERAL
						645	AGRICULTURAL EXTENSION OFFICE
Line Item	Description	Actual 2021-2022 (1)	Budget 2022-2023 (2)	Actual 2022-2023 (3)	Requested 2023-2024 (4)	Proposed 2023-2024 (5)	Adopted 2023-2024 (6)
Personal Services							
1-0305	CLERICAL SALARY	26,192.54	28,420.00	28,770.78	30,873.00	30,873.00	30,873.00
1-0405	PART TIME WAGES	2,225.55	14,000.00	6,606.24	14,000.00	14,000.00	14,000.00
Personal Services Totals		28,418.09	42,420.00	35,377.02	44,873.00	44,873.00	44,873.00
Operating Expenses							
2-0100	POSTAL SERVICES	1,622.14	1,800.00	1,159.50	1,800.00	1,800.00	1,800.00
2-0200	TELEPHONE SERVICES	3,510.63	3,900.00	3,486.34	3,900.00	3,900.00	3,900.00
2-1200	OFFICE EQUIPMENT REPAIR	0.00	150.00	0.00	150.00	150.00	150.00
2-1700	TRAVEL EXPENSES	4,173.31	7,950.00	10,352.53	14,000.00	14,000.00	14,000.00
2-1708	BOARD MEMBERS EXPENSES	1,249.44	1,200.00	534.18	1,200.00	1,200.00	1,200.00
2-9900	MISCELLANEOUS	921.86	1,000.00	147.24	1,000.00	1,000.00	1,000.00
Operating Expenses Totals		11,477.38	16,000.00	15,679.79	22,050.00	22,050.00	22,050.00
Supplies and Materials							
3-0101	OFFICE SUPPLIES	1,053.68	600.00	405.89	600.00	600.00	600.00
3-0118	STATIONARY/ENVELOPES	144.93	450.00	627.14	550.00	550.00	550.00
3-0128	DATA PROCESSING SUPPLIES	2,159.03	2,500.00	1,813.37	2,500.00	2,500.00	2,500.00
Supplies and Materials Totals		3,357.64	3,550.00	2,846.40	3,650.00	3,650.00	3,650.00
Equipment Rental							
4-0200	OFFICE EQUIPMENT RENTAL	503.90	2,080.00	899.00	2,080.00	2,080.00	2,080.00
Equipment Rental Totals		503.90	2,080.00	899.00	2,080.00	2,080.00	2,080.00
Capital Outlay							
5-0500	OFFICE EQUIPMENT	0.00	2,000.00	1,414.06	2,000.00	2,000.00	2,000.00
Capital Outlay Totals		0.00	2,000.00	1,414.06	2,000.00	2,000.00	2,000.00
0100-645 AGRICULTURAL EXTENSION OFFICE TOTAL		43,757.01	66,050.00	56,216.27	74,653.00	74,653.00	74,653.00

Clerical Salary FTE = 1

Part-time Wages FTE = 0.5

Edward Heint

CHERRY COUNTY GENERAL										
Line Item	Description	Actual 2021-2022 (1)	Budget 2022-2023 (2)	Actual 2022-2023 (3)	Requested 2023-2024 (4)	Proposed 2023-2024 (5)	Adopted 2023-2024 (6)			
								Fund	Code	Description
					Function	645	AGRICULTURAL EXTENSION OFFICE			
Personal Services										
1-0305	CLERICAL SALARY	26,192.54	28,420.00	28,770.78	30,873.00	30,873.00	30,873.00			
1-0405	PART TIME WAGES	2,225.55	14,000.00	6,606.24	14,000.00	14,000.00	14,000.00			
	Personal Services Totals	28,418.09	42,420.00	35,377.02	44,873.00	44,873.00	44,873.00			
Operating Expenses										
2-0100	POSTAL SERVICES	1,622.14	1,800.00	1,159.50	1,800.00	1,800.00	1,800.00			
2-0200	TELEPHONE SERVICES	3,510.63	3,900.00	3,486.34	3,900.00	3,900.00	3,900.00			
2-1200	OFFICE EQUIPMENT REPAIR	0.00	150.00	0.00	150.00	150.00	150.00			
2-1700	TRAVEL EXPENSES	4,173.31	7,950.00	10,352.53	14,000.00	14,000.00	14,000.00			
2-1708	BOARD MEMBERS EXPENSES	1,249.44	1,200.00	534.18	1,200.00	1,200.00	1,200.00			
2-9900	MISCELLANEOUS	921.86	1,000.00	147.24	1,000.00	1,000.00	1,000.00			
	Operating Expenses Totals	11,477.38	16,000.00	15,679.79	22,050.00	22,050.00	22,050.00			
Supplies and Materials										
3-0101	OFFICE SUPPLIES	1,053.68	600.00	405.89	600.00	600.00	600.00			
3-0118	STATIONARY/ENVELOPES	144.93	450.00	627.14	550.00	550.00	550.00			
3-0128	DATA PROCESSING SUPPLIES	2,159.03	2,500.00	1,813.37	2,500.00	2,500.00	2,500.00			
	Supplies and Materials Totals	3,357.64	3,550.00	2,846.40	3,650.00	3,650.00	3,650.00			
Equipment Rental										
4-0200	OFFICE EQUIPMENT RENTAL	503.90	2,080.00	899.00	2,080.00	2,080.00	2,080.00			
	Equipment Rental Totals	503.90	2,080.00	899.00	2,080.00	2,080.00	2,080.00			
Capital Outlay										
5-0500	OFFICE EQUIPMENT	0.00	2,000.00	1,414.06	2,000.00	2,000.00	2,000.00			
	Capital Outlay Totals	0.00	2,000.00	1,414.06	2,000.00	2,000.00	2,000.00			
0100-645 AGRICULTURAL EXTENSION OFFICE		43,757.01	66,050.00	56,216.27	74,653.00	74,653.00	74,653.00			
TOTAL										

Clerical Salary FTE = 1
Part-time Wages FTE = 0.5

Cherry County

Impact At-A-Glance



Sandhills Leadership culminated in youth-driven community projects in 5 counties. Valentine students organized an outdoor movie experience that was a feature of a community-wide family event.

The Sandhills Leadership program through UNL Extension has spanned over three decades and has united and inspired high school-aged youth across Blaine, Thomas, Hooker, Grant, and Cherry Counties. Youth not only cultivate a leadership philosophy and hone key skills, they also have the opportunity to apply their learning in “real time” to current community issues. One student said that Sandhills Leadership “made a positive impact on the way I look at things and I have started to view issues from different perspectives while focusing more on my community.”

Programs At-A-Glance

- Approximately 1,500 acres were treated for Eastern Red Cedar utilizing prescribed fire with help from Cherry County Extension with several producers burning for the first time.
- The Nebraska Range Camp was attended by 45 students who learned about plant ID, rotational grazing, prescribed fire, ecological sites and other rangeland topics via hands-on experiences.

170

youth in grades K-8 received training in coding and robotics

**STRENGTHEN NEBRASKA
AGRICULTURE & FOOD SYSTEMS**

79%

of eligible youth were reached through Cherry County 4-H programming

**INSPIRE NEBRASKANS &
THEIR COMMUNITIES**

150

elementary youth were trained in basic disaster preparedness

**ENHANCE THE HEALTH
& WELLBEING OF ALL
NEBRASKANS**



Summary Statement 2023

Ryan Benjamin, Cherry County Beef Systems Educator

This year I wrote 2 Beef Watch Newsletter articles resulting in 1,755 views, as well as a Beef Watch Podcast resulting in 880 downloads, 572 views of articles from previous years and 1,717 downloads of older podcasts. I was also asked to write an article for Progressive Cattleman. I have continued to produce 12 five-minute radio spots (KVSH has potential to reach 10,000 listeners and receives 35,000 views per month on their website) throughout the year to reach a wider audience about timely topics focused mainly on producer topics. I interacted with over 100 producers this year between workshops and individual interactions/consultations.

This year was a little rough for me due to the weather and personal injury. My first several programs I worked on planning had to be canceled because of poor weather conditions that kept producers very busy from early December through the end of March. I had planned to have a Beef Focused Pesticide Training in Valentine with several local educators contributing to the program. I rescheduled the program twice in an effort to get around weather, ultimately, we decided not to have the program.

As a result of the hard winter a local producer had cows in poor body condition and was concerned about calving and keeping those cows going through lactation. I reached out to a few of the specialists and visited the producer to look at the cattle and make a feeding program to keep the cows on the right track through calving and early lactation. With the help of a specialist, I was able to help the producer and learn a lot in the process.

My range program has continued to be a large consumer of my time with a large array of interactions with many different focusses. I spend a significant amount of time working with producers on lease agreements and lease rates. This continues to provide an opportunity to educate and discuss range management topics such as stocking rates, harvest use efficiency, rotational grazing, range health, range monitoring, and other topics. Some of these interactions have led to much deeper conversations than simple lease agreements and rates.

Another focus of my range program has been introducing and educating others about rangelands and rangeland management. One opportunity to do this is through being involved with the Nebraska Range Judging Committee, helping to make decisions around high school range judging competitions as well as helping host and facilitate competitions. I also had the opportunity this year to become involved with the Nebraska Youth Range Camp both as a teacher and a Crew Boss. This allowed me to teach almost 50 high school age students about grazing systems, with a very hands-on game that helped students better grasp concepts. As a crew boss I was responsible for four students for the whole week of the camp and helped them learn range plant identification, ecological site identification and discuss other topics that students learned throughout the week as well as discuss opportunities for career options related to range management. I was also asked to present at the Gudmundsen Sandhills Laboratory Youth Science Field Day on prescribed and wildfire in rangelands. This allowed me to talk to local students about why prescribed fire can be useful in grasslands, woody encroachment and the implications that has, as well as safety concerns with fires and how to prepare for wildfires on the ranch.

Throughout the past year I have interacted with many separate entities that are involved in the prescribed fire community in Nebraska including NRCS, TNC, Pheasants Forever, U.S. Forest Service, Nebraska Forest Service, and local VFDs. I attended several training opportunities both as a student and a coach, allowing me to both increase my skillset and help producers increase their knowledge and ability. In April, I attended a two-week prescribed fire training exchange known as TREX which allowed me to both

learn from other professionals from around the world as well as share my knowledge and experience. Cherry County also had a large wildfire in April that I responded to as part of the volunteer fire department as well as sharing some recovery resources with affected producers. I was also able to help host and teach two producer focused prescribed fire workshops focused on increasing producers' knowledge and skill. These workshops reached around 40 individuals, including many that had never been involved with prescribed fire. These workshops were held in collaboration with several entities including TNC, Pheasants Forever, Nebraska Grazing Lands Coalition and the Great Plains Fire Science Exchange.

I have also continued to be a part of the Niobrara Valley Prescribed Fire Association. This has allowed me to talk to producers that have been using fire as a management tool for some time as well as those just beginning to consider it as a tool. I have also been able to assist several producers and coordinating entities accomplish burning their burn units, resulting in my involvement in burning over 1,500 acres this year.

I have also been involved in the Collaborative Adaptive Management project taking place at the Barta Brothers Ranch which has a large fire element to it, particularly investigating pyric herbivory in the sandhills. This year I planned the prescribed fire and coordinated getting necessary personnel and equipment to accomplish this task. I have also started the planning process for the 2024 burn. I also helped to plan a summer open house as well as a fall stakeholder meeting where early results were discussed as well as plans. These meetings allowed interactions with local producers and discuss woody encroachment as well as possible options of integrating pyric herbivory.

I also taught an online class with Aaron Berger called "Knowing, Growing, and Grazing your Grass" that was a range management focused class. This six-meeting course delved into grass identification, how grass grows, developing grazing plans, stocking rate decisions, risk management, targeted grazing, and terminology. This course was well received with almost 20 attendees. One participant said "I enjoyed the grasslands and range management course you put together this last month. I learned a ton and am grateful I was able to take it with you both. I feel like it's definitely opened my eyes in a lot of ways and also sparked a passion I've got for preserving our precious prairie and grass resources. I'm grateful for the valuable tools and knowledge moving forward. It definitely encouraged me to spend some time studying, learning and asking questions about our own operation that I may not have before along with thinking about our future and ways we can evolve while moving forward." Overall, 36% of participants indicated they had a significant knowledge increase as a result of the course.

Other Contributions 2023

Ryan Benjamin, Cherry County Beef Systems Educator

Professional Development:

Annual Society for Range Management meeting Boise, ID.

Elected to the Young Professionals Conclave officer team, serving as the secretary.

Dr. Rasby's new educator boot camp

Beef educator in-service in March – principles of andragogy and application in our programming

Grants:

Submitted \$50,000 SARE Grant: Plugge B. L., Laborie E., Meyer T.L., Smith H., Benjamin R., Walz T., and Rick Rasby. "Producers Helping Producers – Co- Creating Solutions with New Livestock Producers that Impact Quality of Life, Natural Landscape and Resources, and Economics to Build Success and Sustainability." (Pending)

\$77,186 NRCS Grant: Beckman B., Shick B., Arterburn J., Saner R., Benjamin R., "GrassSnap 2.0: Rangeland Monitoring App Update and Educational Outreach."

\$250,000 ARD McIntire-Stennis Grant: Allen C., Stephenson M., Meredith G., Volesky J., Harvey J., Benjamin R., Martens K., Uden D., Parsons J., Michaels T., "Collaborative Adaptive Management of Rangelands Subject to Woody Expansion."

Publications:

Benjamin, R. (2023, February 1). *How much pasture do I need and what are aums?* UNL Beef. <https://beef.unl.edu/beefwatch/2023/how-much-pasture-do-i-need-and-what-are-aums>

Sanner, R., Eirich, R., & Benjamin, R. (2023, October 1). *Protecting Farms & Ranches from Wildfires*. UNL Beef. <https://beef.unl.edu/beefwatch/2023/protecting-farms-ranches-wildfires>

Workshops:

This year Nebraska BQA held several stockmanship events, I served on the planning committee for the events helping to decide the focuses of each event as well as helping during the events.

Two-day Unit Cost of Production workshop with Aaron Berger in Valentine this fall with 10 participants.

Cow clinic at Valentine Livestock with Rick Rasby and Randy Saner on body condition scoring, teat and udder scoring, rations, and forage sampling in December.

Other:

Moved office locations and other lead educator duties

Served on two search committees

Developed a carcass competition for our 4-H youth beginning at the 2024 Cherry County Fair

Virtual Fence Stakeholder Meeting

Public Value

The Valentine Wildlife Refuge is an important stronghold for many migratory waterfowl as well as other wildlife. The refuge is public land that controls a large stretch of prairie, wetlands, lakes, and marshes that are managed through various means including grazing, fire, hunting, and fishing. Good management of this land provides clean water and food resources for the public.

The Situation

New management techniques have been introduced on the refuge by using virtual fence on the cattle that are grazing allotments. Virtual fence has been portrayed as a way to improve many grazing attributes such as distribution, timing, pressure, etc. Implementation of the virtual fence on the refuge has proved difficult, with many issues presenting themselves through the grazing season, causing permittees to be very disgruntled with the virtual fence system and the wildlife refuge management.

Extension Response

A meeting was held with the virtual fence company, Valentine Wildlife Refuge staff, permittees and the local livestock systems educator with the goal of addressing permittees concerns with refuge management and virtual fence product and make a decision on the continuation of the virtual fence program. Permittees were asked to detail each issue that they had struggled with so refuge staff and the company could better understand issues and how to fix them. The local educator was asked to moderate and bring university research to help discussion.

Impacts

Stakeholders were able to have cordial, honest conversation about the issues and how to address them. Afterwards one of the stakeholders stated "Your patience, expertise and knowledge of UNL research on virtual fencing, was a great asset with the frustration in the crowd. The permittees could

see the potential benefits of virtual fencing to the refuge and their operations."



Participants Feedback

"I wanted to thank you for your assistance at the meeting Wednesday night. Through the meeting, it was great to have your help addressing the concerns and questions from ranchers."

"I can see why you are an asset to the extension service and the local ranching community!"
Refuge Staff

Primary Contact

Ryan Benjamin
Livestock Systems Educator
402-376-1850; ryan.benjamin@unl.edu

Collaborators

Juancarlos Giese, DOI:FWS

Grazing Allotment Permittees

Extension Big 3 Alignment

- ☒ Strengthen Nebraska Agriculture & Food Systems
- ☐ Inspire Nebraskans & Their Communities
- ☐ Enhance The Health & Wellbeing of All Nebraskans



WEDNESDAY, FEBRUARY 1, 2023

How Much Pasture do I Need and What are AUMs?

Ryan Benjamin, Nebraska Extension Educator (/author/ryan-benjamin-nebraska-extension-educator)



Continual pasture condition monitoring, such as photo monitoring, and carefully following weather forecasts should help you make informed stocking rate decisions to keep your pasture as productive as possible. Photo credit Troy Walz.

Determining how much pasture is needed for summer grazing can be difficult. There are many factors that affect pasture productivity including current year precipitation amounts and timing and previous year growing season's conditions. The drought conditions that much of the U.S. experienced last year limited the amount of energy plants were able to store, especially if they were heavily grazed. It is important to consider this when developing a grazing plan for this year. This will aide in understanding how to set stocking rates and prevent further damage.

Many ranchers and government agencies discuss grazing in AUMs (Animal Unit Months). However, this measurement of forage can be confusing for many. AUMs provide a standard unit of measurement for forage needs and availability. One AUM is the amount of forage a 1,000-pound animal will eat in a month or about 780 pounds of air-dry forage (90% dry matter). AUMs are based on body weight to account for variation between classes, ages, and species, The equation to convert any weight of animal to a standard animal unit is:

weight of animal/1,000 = animal unit equivalent.

For example, a yearling weighing 700 lbs. is 0.7 AU (Animal Unit), and a 1,500 lb. animal is 1.5 AU.

To help demonstrate how to utilize this math to calculate pasture needs and carrying capacity, below are a couple example ranches. The first is the Rocking PC Ranch consisting of 400 cows, 14 bulls, 10 horses and a small sheep enterprise. They need to determine how many acres of pasture they will need this year. The Rocking PC has historically had about 6 months of growing season grazing and 2 months of winter grazing, while the remaining 4 months hay is fed.

The Rocking PC Ranch Forage Demand

Summer Pasture Forage Demand

400 pairs x (1300lbs/1000) = 520 AU	520 AU x 6 Months = 3,120 AUM
14 bulls x (2000lbs/1000) = 28 AU	28 AU x 6 Months = 168 AUM
10 horses x (1500 lbs/1000) = 15 AU	15 AU x 6 Months = 90 AUM
100 sheep x (200lbs/1000) = 20 AU	20 AU x 6 Months = 120 AUM
Total requirement	3,498 AUM of Summer Pasture

Winter Pasture Forage Demand

400 pairs x (1300lbs/1000) = 520 AU	520 AU x 2 Months = 1,040 AUM
14 bulls x (2000lbs/1000) = 28 AU	28 AU x 2 Months = 56 AUM
10 horses x (1500 lbs/1000) = 15 AU	15 AU x 2 Months = 30 AUM
100 sheep x (200lbs/1000) = 20 AU	20 AU x 2 Months = 40 AUM
Total requirement	1,166 AUM of Winter Pasture

In the area, forage production averages 1,600 lbs. of forage per acre. Using the "take half- leave half" rule of thumb, this leaves about 800 lbs. of forage for grazing, however, some of this will be lost due to trampling and soiling, plant material consumed by wildlife, or plant material that is just not consumed. For most limited management systems, the amount of forage actually consumed by the grazers is around 25-30%, meaning about 480 lbs. per acre is used to feed the animals. This is referred to as harvest efficiency, and refers to the amount of forage consumed, the amount of forage lost to trampling, and the forage left for plant health and vigor. Harvest efficiency can range from 20% in season long grazing (20% consumed) to 35% in some rotational grazing systems. Winter grazed pastures are often grazed more heavily without harming the pasture health. For this example, 50% of winter forage is consumed ([ec127.pdf \(unl.edu\)](https://extensionpublications.unl.edu/assets/pdf/ec127.pdf)) (<https://extensionpublications.unl.edu/assets/pdf/ec127.pdf>).

Acres of pasture or forage supply

3,498 AUM x 780 lbs. = 2,728,440 lbs. of forage required. If only 30% of forage is consumed by cattle (30% harvest efficiency, 20% trampled/loss, 50% for plant vigor = 100% of plant production), divide by 0.3 to determine total pounds of forage required and then divide by the lbs. per acre produced to determine the number of acres. For example,

2,728,440 lbs./0.3 = 9,094,800 lbs. of total forage required

9,094,800 lbs. of total forage required /1,600 lbs./ac (supply) = 5,684.25 acres of pasture needed for summer grazing.

This same process can be repeated to determine winter grazing acres:

1,166 AUM x 780 lbs.=909,480 lbs./0.5 = 1,818,960 lbs./1,600 lbs./ac = 1,136.85 acres of winter pasture.

The total number of pasture acres required by the Rocking PC Ranch is 6,821.1 acres. This does not include hay ground or feed required for the other 4 months of the winter. This estimation also assumes normal or average conditions. During drought more acres will be required, or forage demand may have to be reduced.

Carrying Capacity

This process can also be done in reverse, with a set number of acres to determine the number of animals and amount of time they can be on pasture. A ranch consists of 4,000 acres averaging 1,400 lbs. of forage per acre and wants to run some yearlings for 5 months starting at 600 lbs. and selling at 900 lbs. (averaging 750 lbs. while on pasture).

4,000 acres x 1,400 lbs./ac.=5,600,000 lbs. x 0.3 (harvest efficiency) = 1,680,000 lbs./780 lbs./AUM= 2,153.85 AUM/5 Months= 430 AU

750 lbs. (average weight)/1,000= 0.75 AU

430 AU/0.75 AU= 574 Yearlings

Drought Management

There are many factors that play into forage production on pasture, especially native rangelands. During periods of drought, forage production can be greatly reduced and can have effects that last into following years. This is compounded by the length of the drought, drought severity, and management decisions. Knowing and understanding the previous year's grazing pressure and drought severity aides in assessing how plants will recover after a period of drought. In general, keeping stocking rates lower than normal and increasing rest periods can help pastures recover more quickly. Drought severity and grazing pressure should be the driving forces of post-drought management decisions. Having a plan for drought ahead of time is helpful in successfully managing through a drought. If drought conditions persist for multiple years, stocking rates must be reduced to match forage production. There are tools such as [GrassCast \[https://grasscast.unl.edu/\]](https://grasscast.unl.edu/), the [rangeland analysis platform](#) , and [NOAAs season long forecast](#) that can help livestock managers forecast possible drought conditions coming and help with developing a plan for lowering stocking rates ahead of drought. Having set decisions points allows you to take some of the emotion out of tough management decisions. Giving your pasture time to recover is imperative after a multi-year drought. Continual pasture condition monitoring, such as photo monitoring, and carefully following weather forecasts should help you make informed stocking rate decisions to keep your pasture as productive as possible.

Resources:

[Grazing Systems for Nebraska Sandhills Rangeland](https://extensionpubs.unl.edu/publication/9000016368104/grazing-systems-for-nebraska-sandhills-rangeland/)

[\[https://extensionpubs.unl.edu/publication/9000016368104/grazing-systems-for-nebraska-sandhills-rangeland/\]](https://extensionpubs.unl.edu/publication/9000016368104/grazing-systems-for-nebraska-sandhills-rangeland/)Grass-Cast

[\[https://grasscast.unl.edu/\]](https://grasscast.unl.edu/)Rangeland Analysis Platform

[NOAAs season long forecast](#)

Interviews with the authors of BeefWatch newsletter articles become available throughout the month of publication and are accessible at <https://go.unl.edu/podcast> [https://go.unl.edu/podcast].

North Central Nebraska PRESCRIBED BURN WORKSHOP



Wednesday , May 31
8:30am

ABOUT

Join us in learning about prescribed burning and participate in a prescribed burn during the afternoon, weather permitting. The workshop will be held at the Keya Paha County Fairgrounds in Norden, NE.

TOPICS

- Reasons for burning
- Regulations affecting prescribed burning
- Formulating a burn plan
- Prescribed Burn Associations
- Equipment Demos
- Much More

Free Registration, Lunch Provided

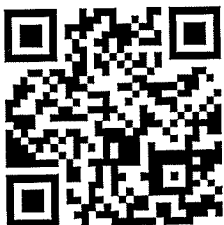

Online:
<https://rb.gy/76eq1>

Call : Cherry County Extension
(402) 376-1850

More information: www.GPFireScience.org

N EXTENSION

Knowing, Growing and Grazing Grass Webinar Series: October 23, 26, 30, November 2, 6, 9

Would you like to grow your grass knowledge and better understand range and pasture resources? Nebraska Extension will host a six-session webinar series on Monday and Thursday evenings beginning October 3 through November 9 from 7:30 - 8:45 p.m. CT that will explain the basics of knowing, growing and grazing grass.

Topics will include:

- Identifying key grass species you want more of in your pastures.
- Understanding factors that influence grass growth and vigor on your operation.
- Calculating stocking rates and what the numbers mean for grazing management.
- Developing a grazing plan for your resource base, including drought management decision dates.
- Using the USDA Web Soil Survey to see what grass production could be.
- Understanding Pasture Range and Forage (PRF) insurance as a drought risk management tool.

Cost is \$85 per person and includes a copy of Grassland Plants of South Dakota and the Northern Great Plains and a resource notebook with Nebraska Extension NebGuides and Circulars. The course will be limited to 25 participants. To register, go to https://go.unl.edu/Knowing_Grass. Register by Oct 16 to ensure participants receive webinar resources before the series begins. A computer and internet connection will be needed to participate in the webinar series.

For questions about the webinar series, please contact Aaron Berger, Nebraska Extension Educator at 308-235-3122 or aberger2@unl.edu.

Impacts and Accomplishments 2023

Michelle Garwood, 4-H Educator in Cherry County & Central Sandhills

As I complete my fifth year of service to the UNL Extension 4-H program on the county level, I once again marvel at the number of changes that have occurred. Along with my colleagues, I continue to be flexible and resourceful and work hard at prioritizing limited time and resources over a large geographical area. The area of Excellence in Extension I feel I leaned into this year was "Meaningful". After five years of serving these communities, I feel that partner and clientele relationships deepened and program offerings became even more tailored to learner needs. I am becoming a more familiar face in some of the schools and youth who are not enrolled in traditional 4-H are enthusiastically recognizing me as a trusted teacher. I am also settling into a more routine schedule with my partners as they invite me back to repeat select programs.

Here is a summary of accomplishments related to my 2023 Individual Action Plan:

Leadership Team (long/medium/short-term goals)

I served as a co-leader for the State 4-H Youth Leadership Focus Group and played a key role in coordinating professional development experiences for my colleagues. Two new educational products were completed this year (Teen Leader Toolkit & Purple Ribbon Kid Elementary Lesson Plans), and I played a role as a co-author on both. For the State Youth Leadership Conference Ambassador team, I served as a committee member, and helped navigate the decision-making process as we transitioned from the Halsey Camp setting after the fire.

On the regional level, I teamed up with colleagues from the Panhandle to deliver the LOG-N Leadership Camp for middle school students. Due to the loss of Halsey, I offered to host the camp along the Niobrara River, utilizing my local outdoor education partnerships to make an affordable and memorable experience. Twenty-one youth from seven counties attended. On a scale of one to ten, 88% of the participants ranked the overall experience at a seven or above! Youth honed their leadership skills while navigating challenges in the outdoors such as canoeing and a survival scenario.

The Sandhills Leadership program continued to grow. In the spring, 39 youth engaged in community-based projects including a community center clean-up in Dunning, the establishment of a Free Little Food Pantry in Thedford, advocacy research for the nursing home crisis in Mullen, and an outdoor community movie experience in Valentine. Hyannis began a discussion on a volunteer-based movie theater utilizing the new school auditorium and Cody began work on a Free Little Food Pantry for their community. This Fall, a new Sandhills Leadership cohort of 30 youth kicked-off with a retreat along the Niobrara River and they will also pursue real-time community projects in the spring semester after the completion of the classroom portion of the experience. One student said that Sandhills Leadership "made a positive impact on the way I look at things and I have started to view issues from different perspectives while focusing more on my community." This program was funded by the Sandhills Area Foundation for the past two years for a total of \$5,100.

All Valentine Elementary 6th graders (37) were reached through a full-day Leadership Summit school enrichment experience. This program is serving as a powerful "pre-experience" for the Sandhills Leadership program that is offered in high school. Statewide, 64% of youth feel they are more confident in their abilities to positively influence their community, as a result of the program. In Cherry County, Leadership Summit is funded as part of the Sandhills Leadership program through the Sandhills Area Foundation grant mentioned above.

Another local impact was the participation of two Junior Leaders on our 4-H Council the past year, with the two seats being filled again for the upcoming year. Youth voice was finally consistently present in all major decisions in our county program, from award choices, to fundraising strategies, to workshop

choices, and much more. The youth served in leadership roles at workshops, County Fair, and Achievement Night.

Healthy Living Team (medium/short term goals)

- Through a \$950 Healthy Habits two-year grant from the Walmart Foundation, I was able to deliver the 7-hour program to 93 youth across Cherry County. This program helps me reach every middle school student and every 9th grader at Cody/Kilgore school. Basic food prep, My Plate, food label reading, and healthy food/drink choices are main topics covered. Statewide, the following impacts have been reported as a result of the program:
 - 87% of youth learned about healthy food choices.
 - 73% of youth plan to stay physically active.
 - 72% of youth gave their family ideas for healthy meals or snacks.
- The Health Rocks curriculum was delivered at Zion Lutheran School as school enrichment.
- Approximately 183 miles of physical activity were recorded by Cherry County youth who participated in the Marathon Kids summer program.

Notable short-term outcomes in various topic areas:

Embryology

- The Valentine Children & Families Coalition granted funding to purchase two additional incubators to allow expansion of this program (\$357.98).
- Youth at Zion Lutheran School and Cutcomb Rural School participated in the program. In addition, the Early Childhood Educator position is vacant for our county, so I assisted two daycares with implementing the program, and the Zion preschool also engaged with the program that was already in place for the older students.

Robotics

- All youth at Kilgore Elementary school engaged in nine 30-minute school enrichment sessions of Jr. Robotics.
- All youth in the Valentine After School Program engaged in four sessions of Jr. Robotics.
- For youth not enrolled in the VES after school program, a second 4-week program was offered for Jr. Robotics.
- The First Lego Robotics program for middle school students culminated in two teams competing at the District level (resulting in a 2nd place award in Innovation), and one team advanced to the State Competition (resulting in a 2nd place award in Innovation). Between the two teams, at least 79 hours of direct instruction occurred via three volunteers, over a period of five months.
- One summer workshop was held in Kilgore to continue to peak interest in the topic and recruit possible future volunteers.
- A total of 170 youth were reached through all robotics programs in 2023, a new record for Cherry County.

Deliver Outdoor Education through a variety of methods

Through partnerships with local agencies and Valentine schools, 299 Cherry County youth were reached through outdoor education programs. The entire Valentine Elementary received basic disaster preparedness instruction. The annual Niobrara Nature Fest program reached an additional 56 youth in surrounding counties in addition to all Valentine 5th graders. The Arbor Day Festival in Halsey reached all Valentine 4th graders, plus an additional 98 youth in Central Sandhills schools. Programs were delivered via school enrichment, after school programs, and summer camps/workshops.

Other Accomplishments

Traditional 4-H & CWF

- For the first time in my five-year career, there was a notable increase in enrollment in traditional 4-H, approximately 12%
- Overall youth reach in Cherry County over the past two years has been around 70%.
- Youth reach increased in all four Central Sandhills counties in my Accountability Region.
- Fourteen high school youth attend the Citizenship Washington Focus trip in 2023.
- I provided a second year of oversight for one high school STEM CARES student-led summer workshop.
- Twenty-three Quilts of Valor were awarded to Veterans by 4-H members.
- Fifty market beef animals were exhibited in 2023, compared with 32 in 2022.
- One of my goals for traditional 4-H has been to encourage youth to explore opportunities beyond the county program.
 - There has been an approximate 59% increase of entries by Cherry Co. 4-H members in live state-level competitions over my 5-year career.
 - One Cherry Co. 4-H member was a member of the National 4-H Shooting Sports team (second year in a row).

Professional Organizations

- NCEA 4-H Section – 4 years
- NACEE (Nebraska Alliance for Conservation & Environmental Education) – Joined Fall 2023

Awards

- NAE4-HYDP National Achievement in Service Award
- NCEA 4-H Section Communicator Award (Weekly Radio Report)
- UNL 5 Year Service Award

Service (State 4-H)

- State Fair 4-H Superintendent
- State Fair Advisory Committee (began Fall 2023)
- Youth Leadership Focus Group Co-Leader

Service (Extension-Wide)

- Question, Persuade, Refer (QPR) Suicide Prevention Instructor Team Member
- NCEA Member Services Committee Member
- Co Lead Educator for County Extension Office
- Participated in NACEB Legislative Day

Service (Community-Based)

- Valentine Children & Families Coalition Member
- Niobrara Valley Outdoor Education Partnership Member
- Healthy Choices 4 Cherry County Coalition (DHHS funded) Member
- Leo Brinda Unit #90 American Legion Auxiliary (Vice-President)
- Zion Lutheran School Parent Teacher Organization
- Our Savior Lutheran Church Youth Program Co-Leader & Lutheran Women's Missionary League (Secretary/Treasurer)

Cherry Co. & Central Sandhills 4-H

Public Value

Youth ages 5-19 are 21% of Nebraska Communities and they will soon fill critical roles in economic and civic leadership of Nebraska. It is estimated that over the next ten years the transfer of wealth will be 100 billion. The transfer of leadership will be as significant, approximately 75 million Boomers are expected to retire by 2030 in the U.S.

The Situation

Youth are growing and emerging into adulthood during an ever-changing, uncertain, complex and ambiguous time and youth need developmentally appropriate opportunities to prepare them to navigate their futures.

Extension Response

Preparing youth to thrive in adulthood will be essential to the economic vitality and civic wellness of all Nebraska communities. Nebraska 4-H is preparing youth to make informed decisions, engaging youth in STEM and Agriculture, and is inspiring youth to be the leaders and entrepreneurs of the next generation.

Impacts

- In five Sandhills counties, 39 youth coordinated community projects after receiving approximately 12 hours of leadership training.
- In grades K-8 in Cherry Co., 170 youth received robotics instruction and the First Lego League team received 2nd place in the Innovation Project at the state level.
- Disaster preparedness was delivered to 150 youth and 93 students received nutrition education in Cherry County.

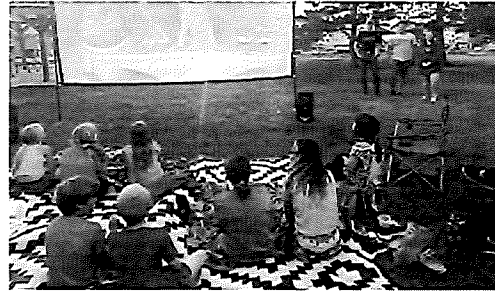

Sandhills Leadership youth organized an outdoor movie night for the community.

Participants Feedback

One student said that Sandhills Leadership “made a positive impact on the way I look at things and I have started to view issues from different perspectives while focusing more on my community.”

Primary Contact

Michelle Garwood, M.S.
UNL Extension in Cherry Co. & Central Sandhills
402-376-1850, mgarwood3@unl.edu

Collaborators

Shaniya Albertus, UNL Ext. in Central Sandhills
Wendy Murphy, Niobrara Council

Extension Big 3 Alignment (check the box that best applies. Double-click on box to check)

- ☐ Strengthen Nebraska Agriculture & Food Systems
- ☒ Inspire Nebraskans & Their Communities
- ☐ Enhance The Health & Wellbeing of All Nebraskans



smore



Share



Translate



Accessibility



263

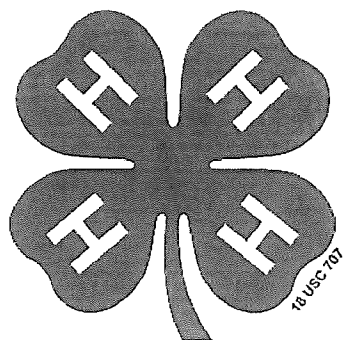

Contact Information

Nebraska Extension in Cherry County

365 N Main St. Suite 3

Valentine, NE 69201

Visit our [website](#)

Follow us on [Facebook](#)

Michelle Garwood, 4-H Educator

mgarwood3@unl.edu

402-376-1850



**Want to stay up-do-date via text messages?
Contact Andrea to sign up for our Remind App
system!**

Calendar of Events

UPCOMING DUE DATES (Bold=Local)

April 11 - CEA Contest Pre-Entry Deadline

May 1 - Cherry Co. 4-H Council Project & Club Grants

May 15 - Summer Sign-Up Deadline

June 1 - Livestock & Horse ID Forms

June 15 - 4-H Enrollment Deadline

June 15 - State Fair Livestock Nomination Deadline

June 30 - Clothing & Special Foods Contest Pre-Entry Forms

July 14 - Pre-Fair Entry Forms, YQCA, and Horse Levels

LOCAL EVENTS

* = open to Clover Kids ages 5-7

April 11 - *Jr. Robotics @ Ext. Office, 3:45-5:15 pm CT

April 12 - Sandhills Production Meeting @ VHS, 3:30-5:30 pm CT (Cody/Kilgore date coming soon)

April 14 - *CEA Contest @ Valentine Methodist Church, 5:00 pm CT

April 17-21 - Volunteer Week Zoom Lunch & Learn Sessions

April 18 - *Jr. Robotics @ Ext. Office, 3:45-5:15 pm CT

April 25 - *Jr. Robotics @ Ext. Office, 3:45-5:15 pm CT

May 1 - *I



smore

263

May 20 -

May 22 - Babysitting Basics Class @ Valentine, 8:30-4:30 CT

May 23 - *Niobrara Council Summer Camp Pre-K @ Valentine

May 24-25 - *Niobrara Council Summer Camp Grades K-1 @ Valentine

May 30 - *Livestock Judging Contest & Clinic @ Cherry Co. Fairgrounds, 9:00 am

May 30 - YQCA @ Cherry Co. Fairgrounds, 1:00 pm CT

May 31-June 1 - Regional LOG-N Leadership for Grades 5-7 @ Valentine

June 5-18 - Cherry Co. CWF Trip

June 5-6 - Design Camp @ Valentine

June 7 - *4-H Leads Summer Reading Program @ Valentine Library, 10:00-11:00 am

June 7 - *Clover Kid College @ Ext. Office, 1:00-5:00 pm

June 8 - Babysitting Basics Class @ Cody TBD, 8:30 am - 4:30 pm MT

June 9-10 - Heart City Cattle Battle w/ Showmanship & Fitting Clinics @ Cherry Co. Fairgrounds (not a 4-H sponsored event)

June 12 - Clothing 1 and Shopping in Style/Modeling Workshop @ Valentine, time TBD

June 13 - *Dog & Small Animal Workshops @ Valentine, TBD

June 14 - *4-H Leads Summer Reading Program @ Valentine Library, 10:00-11:00 am

June 15 - *Sign Workshops with Joanna Connot @ Cody & Valentine, TBD

June 19-23 - Missoula Children's Theater (not a 4-H sponsored event)

June 26-27 - Niobrara Council Summer Camp Grades 4-5 @ Valentine

June 28-29 - Niobrara Council Summer Camp Grades 2-3 @ Valentine

July 6-11 - Potential Photography, Foods, and Horticulture Workshops, TBA

July 12 - YQCA and *Clover Kid College @ Kilgore, TBD

July 13 - Clothing & Textiles Judging Day @ Ext. Office

July 17-18 - Mech Tech Field Trip (Tentative) for STEM & Robotics

July 19 - *Robotics Exploration Day @ Cody, 8:00-11:00 am MT

July 19 - *Clover Kid College @ Cody, 12:00-4:00 pm MT

July 20 - Special Foods Day & Cupcake Wars Contests @ Valentine, TBD

August 4-5 - Cherry Co. Fair Shooting Sports Contests

August 8-13 - Cherry Co. Fair 4-H Events

HIGHLIGHTED REGIONAL/STATE/NATIONAL EVENTS

May 22-June 8 - Tractor Safety Training (various locations/options)

May 25 - NCTA Animal Science Day

June 11-16 - Big Red Academic Camps (High School) @ Lincoln, NE

June 19-21 - State 4-H Youth Leadership Conference @ Camp Comeca

June 21-22 - PASE (Premier Animal Science Event) @ Lincoln, NE

June 23 - State Presentation & Speech Contest @ Lincoln, NE

June 27 - Agronomy Youth Field Day @ Curtis, NE

July 15-19 - State 4-H Horse Expo @ Grand Island

New - summer sign up form for 2023!

Our sumr

NEW this



smore

263

er
Fun

available on May 1 with ALL summer learning experiences listed.

Please mark everything you hope to attend and return the form to the Extension Office **by May 15**. Any workshops fees are due upon arrival at the event unless otherwise stated.

Some events are highlighted in this newsletter. Additional events will be highlighted with the release of the sign up form. Let us know if you have any questions on items on the current calendar. A few items are still in development such as horse practices/clinics, dog practices, and shooting sports practices.



4-H enrollment open, all volunteers **MUST** do DHHS screening this year in Cherry Co.!

Anyone participating in activities (Quilts of Valor, CWF, robotics, etc.) **MUST** re-enroll immediately, along with any active volunteers. Enrollment stays open through June 15 and you can add and drop projects during that open time. Don't forget that you must pay your \$5 enrollment fee to the Extension Office for the process to be complete. Plus, it's always best to work on your projects year-round, so don't hesitate to get started! **VOLUNTEERS - PLEASE**

NOTE THAT IN 2023, CHERRY COUNTY IS DUE IN THE 5 YEAR ROTATION FOR ALL VOLUNTEERS TO DO A NEW BACKGROUND CHECK THROUGH DHSS.

4-H LEADERS

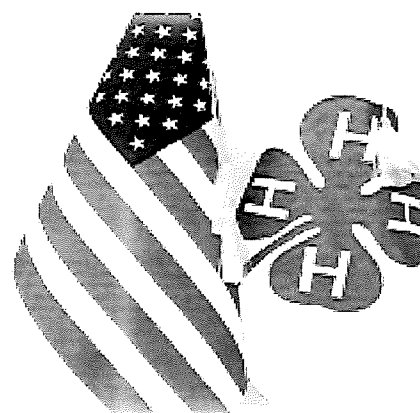

Cherry County 4-H Council welcomes several new leaders!

The 4-H Council is here to serve YOU! Be sure to visit with members about ideas or suggestions you have for Cherry County 4-H. These individuals help lead committees, organize the annual Luck of the Draw fundraiser, play multiple roles at Fair and year-round events, handle decisions/issues related to the program, manage the program budget, and much more. We are pleased to announce that our two youth rep seats are filled this year!!! Youth ages 14 and up can run for 1-year terms.

President- Connor Barnes

Vice President - Sherry Slagowski

Treasurer- Laura Willert



Bodell Bachelor, Amanda Jones

Youth Members: Wesley Willert and Jocelyn Jordan

Grant money available for youth projects and clubs

The Cherry County 4-H Council has youth project grants and club grants available! Please see <https://extension.unl.edu/.../cherry-county-4-h-resources/> for more information and an application form. Applications are due May 1. Youth who receive funding for a project are expected to have a presentation board at the 2023 Achievement Day in the fall.

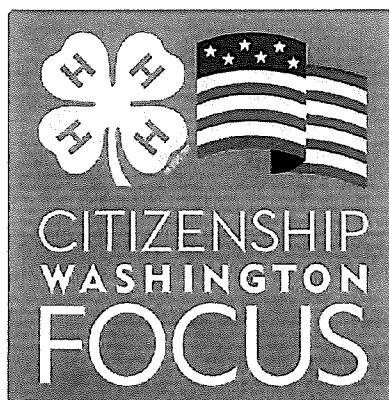

CWF sign up for 2025!

We are actively seeking more youth to enroll in the CWF 2025 cohort, and some youth are already fundraising for this trip. If you know of someone who will be 14 by June of 2025, have them get involved in this once-in-a-lifetime experience! The trip costs approximately \$3,000, so we encourage youth to start fundraising as soon as possible. Simply contact the office at 402-376-1850 to enroll. Youth do NOT need to be current 4-H members.

NEW age of eligibility for 4-H State Fair contests!

From the Nebraska State 4-H Office



With each new State Fair season, brings new possibilities and opportunities for 4-H families in Nebraska. The opportunity for 4-H to continue having its own weekend allows more flexibility for new events, entry limits, schedules, and space. We want to continue to take advantage of that!

As part of that process, we continue to explore age eligibility requirements for State Fair participation. After garnering user input, researching data from other events/shows/states, and looking that overall impact on youth development, the decision has been made to change **the age of eligibility in 2023 to be 9 years of age before January 1 (of the current year) for all in-person events (livestock, contests, fashion shows).**

More information will be forthcoming.

Please note, this change applies to State 4-H contests. The eligible age range for 4-H project enrollment is still 8-18, as of January 1. Clover Kids must be 5-7 years of age as of January 1.

Plan Your Year with the 4-H Diamond Clover Program

Want to learn how to start the Diamond Clover program for 2023?? Visit <https://4h.unl.edu/diamond-clover> and talk to Michelle! It's a great way to plan out your 4-H year



clubs, etc.). Levels 4-6 are perfect for youth wanting to plan their own service projects and grow leadership skills. And after working your way through the 6 levels, you earn a Diamond Clover pin!

Communications & Expressive Arts Contest April 14, 2023

The annual Communications and Expressive Arts Contest will start at 5:00 pm CT at Valentine Methodist Church on April 14. 4-H leader, Angie Jordan, is willing to help edit your speech, give you pointers, etc. if you set up an appointment with her: 402-322-1233. Don't forget, there is a local cowboy poetry category too! *The PSA theme for 2023 is "Discover Your Spark in Nebraska 4-H" and the final electronic copy of your PSA must be e-mailed as a MP3 file to mgarwood3@unl.edu by April 11. All entry forms are also DUE April 11. See the [Cherry Co. 4-H website](#) for entry forms and a set of guidelines, or stop in the Extension Office for a copy.*



NEW for 2023!!! State Presentations Contest combined with State Speech June 23

The Nebraska State 4-H Presentations Contest will partner with the State 4-H Public Speaking Contest to create a combined state-level communications event – this event will be called the **Premier Communication Event** and will be held on the **University of Nebraska-Lincoln East Campus** on **Friday, June 23, 2023**.

Qualification will be similar to previous years and will be outlined in our county CEA guidelines.

- Canoeing
- Hiking
- Service Learning Project
- Leadership Skills
- Creating Memories!
- And More!

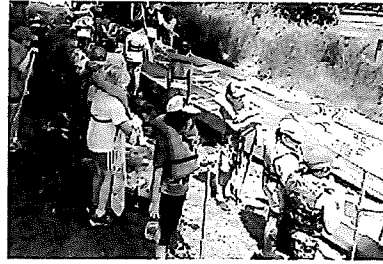

LOG N

Leadership Opportunities for Growth in Nebraska 4-H

In partnership with the Niobrara Council

"RESILIENCE ON THE RIVER"

Location: Valentine, Nebraska

Date: May 31st-June 1st

Cost: \$80

(Scholarship maybe available, contact your local 4-H Council)

Grades: 5th-7th grade In 2022-2023

The University does not discriminate based upon any protected status. Please see go.unl.edu/unlnondiscrimination. Copyright (c) 2023



To Apply Contact:
 Nebraska Extension-
 Garden County - Sarah
 308-772-3311
 Box Butte County - Melissa
 308-762-5616
 Cherry County-Michelle
 402-376-1850
 Registration Form:
<https://go.unl.edu/logn2023>

Barn Quilt Kick Off Parent Meeting

Join us at lunch to learn about making quilts without sewing a stitch! We have traditionally offered this project in an ongoing "lab" setting during the summer with leader, Rhonda Cherry. Meet at the Extension Office from 12-1 on May 1 to discuss scheduling, supplies, techniques, and possible pattern choices. Barn Quilts come in different sizes and Clover Kids are welcome! Families are responsible for purchasing paint and the 4-H Council provides the other materials.

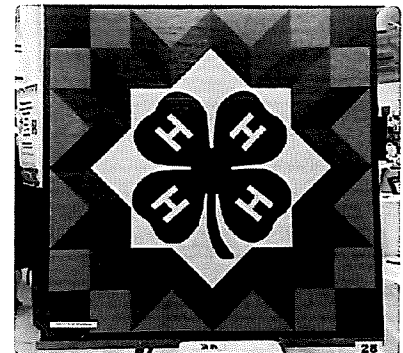

Thrift Store Challenge Field Trip to Rapid City May 20

Upcycling and vintage are all the rage! Did you know there is a 4-H project for that? Kick off the summer with a day trip to Rapid City to explore hidden treasures in thrift stores and dream up ways to upcycle or style your finds. This trip will be open for ages 8-18 and adult chaperones are encouraged. Register for this event on the

Summer:
purchase



263

Babysitting Basics Classes

Want to start a new business venture this summer or boost your confidence to help out with your younger siblings? Become a UNL Extension Certified Babysitter through this course that covers the basics from safety to nutrition and age-appropriate activities. There will be an option to become certified in CPR and First Aid at a later date, if interested. This class is for ages 12 to 18. The class will be taught all in one day with two chances to join the fun.

May 22 @ the Extension Office, 8:30 am - 4:30 pm

June 8 @ Cody/Kilgore site TBD, 8:30 am - 4:30 pm MT

Watch for the summer sign up form coming May 1 to register for this activity. This class is free.

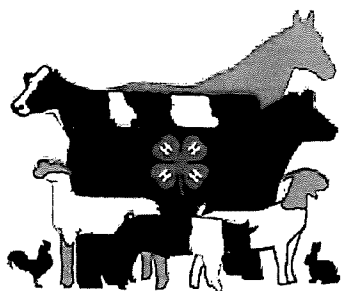

Important Livestock Info!

Are you planning to take the **Sandhills Production** project for any species in 2023? There will be an informational meeting on **April 12 from 3:30-5:30 pm** (come and go as you can) in Mr. Nollette's room at Valentine High School. Please contact the Extension Office by that time if you plan to take this project in the Cody-Kilgore area so we can coordinate a second meeting time out

West. Parents/guardians/leaders are encouraged to attend with the youth.

Be sure to stop into the office soon to get **Livestock ID forms** (also available on our website) and **ear tags** for market animals. If you are planning to compete at State Fair, please let us know and pick up e-ID tags and DNA envelopes.

Sharpen your skills at the annual **Livestock Clinic & Judging Contest on May 30**. Doug Smith from NCTA will be our clinician again this year. The day will begin at 9:00 am at the Cherry County Fairgrounds. Clover Kids and adults are welcome! After Judging, there will be an in-person **YQCA** class at 1:00 pm at the Fairgrounds.

YQCA is required each year for all youth ages 8-18 enrolled in Livestock projects (including Poultry and Rabbit). You may take the class online at yqca.org or participate in an in-person class. In addition to the class offered after Livestock Judging, a second class will be offered in Cody on July 12, time TBD.

Important deadlines:

- **June 1** - All livestock IDs and Horse IDs due (includes photos of tagged market animals)
- **June 15** - State Fair Nominations Due (please inform Extension Office by June 1 if you are planning to nominate)



Stay in the loop!

- Watch your e-mail for **instructions on how to submit photos** of tagged market animals!
- We have a Cherry Co. 4-H Livestock **private Facebook group** - let us know if you want to join! It's a great way to keep up-to-date, especially with fast-moving information around Fair time.
- Also consider signing up for **Remind text messages** - contact Andrea at 402-376-1850.

Changes to the Horse program were in the last newsletter - basically there are no longer District Contests. The Cherry Co. 4-H Horse Packet will be coming soon! Visit the State website to learn about the State 4-H Horse Expo, along with deadlines and requirements!

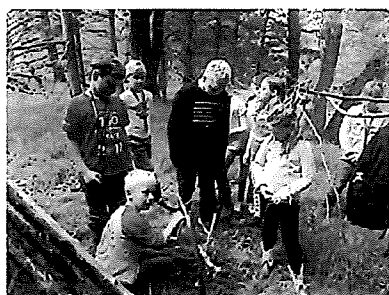

Niobrara Council Summer Camp Partnership

We continue to enjoy a close partnership with Niobrara Council. If you are taking Outdoor projects in 4-H, these camps are a great way to work on your exhibits! Watch your backpacks for papers to come home from school, or contact the Niobrara Council at 402-376-2793. See dates on the calendar above.

Town & Country 4-H Club

The Town & Country 4-H Club continues to meet monthly to work on projects and help new and veteran families bond and learn more about the program! They meet from 3:45-5:00 pm at the Valentine Methodist Church during the school year. The last two school year dates are:

April 17

May 15

Summer meeting details:

12:30-3:00 pm

Valentine Methodist Church

June 15

July 11



Do you have
in our new  **smore**

 263 **le them**

Call for State Contests! Let's practice and develop teams!

Are you interested in participating in a State 4-H Competition this summer? Let us help you prepare and/or connect you with teammates! There are several to choose from, but here are a few highlights or learn more from the [State Fairbook](#):

- Premier Animal Science Event in Lincoln, June 21-22
- Horticulture Judging @ State Fair
- Weed and Grass ID, Tree ID @ State Fair
- Culinary Competition @ State Fair
- Robotics Showcase @ State Fair

2023 Special Gardening Project

This year, 4-H horticulture members will work with the Mrs. Burns' Lemon Basil which is a versatile plant that can add a lemony flavor to any recipe or a fresh scent to floral arrangements.

Visit 4h.unl.edu/sgp to learn more about the Special Garden Project and how to get started. Seeds are now available at the Extension Office.



2023 Special Agronomy Project

Youth taking the Special Agronomy Project this year will work with Tepary Beans (pronounced tep-uh-ree). These are among the most drought-tolerant legume crops in the world, but at one time, they were almost an endangered species in the United States.

Visit 4h.unl.edu/sap to learn more about the Special Agronomy Project and how to get started. The Cherry Co. Extension Office currently has seeds available.



Tractor Safety Training 2023

Tractor and farm equipment safety courses are now open for registration!

Teens 14 or 15 years of age who work on farms, or others who are interested in learning about tractor and farm equipment safety practices, can register for a safety training course offered at seven locations across Nebraska from May 22 through June 8. Learn more at go.unl.edu/2023tractorsafety.

Nebraska
High School smore

We have a new location and date for the 2023 Youth Leadership Conference (after the Halsey fire)! It will be held June 19-21 at Comeca Camp and Retreat Center.

The YLC Ambassadors are currently planning the conference, and more details will be shared as plans are finalized. Stay tuned to 4h.unl.edu/ylc for updates. Michelle is on the planning committee and carpooling will be available.



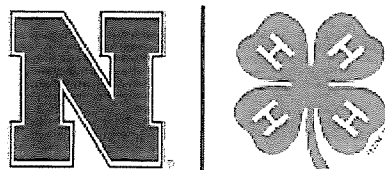

WEEK OF THE
VOLUNTEER

LUNCH & LEARN

APRIL 17-21 @ NOON CT

4h.unl.edu/volunteer-lunch-learn

Calling all Nebraska 4-H volunteers!

You're invited to our Week of the Volunteer Lunch & Learn Series! We'll help you excel in your volunteer role and maximize your impact!

4-H Club Meeting 101 - Monday, April 17

Creating a Vibrant 4-H Club Experience - Tuesday, April 18

YOU Help Youth Thrive - Wednesday, April 19

Shared Leadership & Succession Planning for 4-H Clubs - Thursday, April 20

Find more details and register at 4h.unl.edu/volunteer-lunch-learn.



SAVE THE DATE

4-H HORSE CAMP

June 8-10, 2023
Fort Robinson State Park
Crawford, NE



*"Through These Doors Have Walked
Some of the World's Finest Horsemen"*

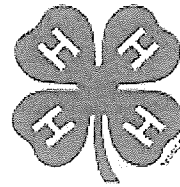
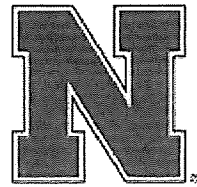
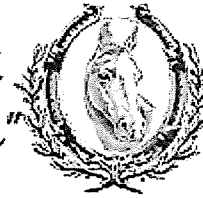



ANIMAL SCIENCE DISCOVER DAY

EXTENSION

Youth ages 8-18 will interact with Animal Science faculty and educators, gain knowledge of the livestock industry and explore careers in animal science.

May 25, 2023

9:00am – 3:00pm CT

NCTA Campus in Curtis, NE

Cost: \$15 includes lunch

Register by May 21

Late registrations \$20

Registration link:

<https://cvent.me/mP1GMA>

When registering you will need a separate email for each child. To pay for multiple children register first child then click "Add Group Member" to add next child.



NCTA's Educational Center,
Curtis, NE

R

CO-OP

TECHNICAL AGRICULTURE



7TH ANNUAL AGRONOMY YOUTH FIELD DAY

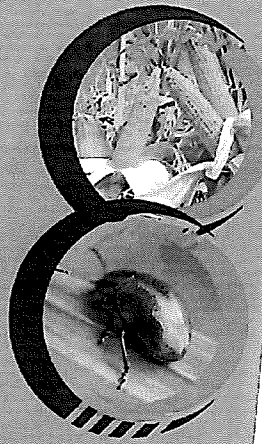

Two Different Age Tracts

Open state wide to ALL youth ages 9-18 as of 1/1/23. Parents and adults are welcome! FREE event with lunch provided by Ag Valley Coop.

Hands on Activities

Learn how agriculture is changing with precision technology; benefits of cover crops; how to tell if soil is healthy; explore plant growth by dissecting plants; understand importance of weeds & herbicide application technology; how to scout crops for insects; & fly a miniature drone!

Sign Up

Register Today!

Register online at go.unl.edu/agronomy-youth-field-day or by scanning the code by June 20th. For more information, contact Nebraska Extension-Frontier County at (308)367-4424 or email kathy.burr@unl.edu.



Nebraska Extension is a Division of the Institute of Agriculture and Natural Resources at the University of Nebraska-Lincoln cooperating with the Counties and the United States Department of Agriculture.





Nebraska Extension educational programs abide with the nondiscrimination policies of the University of Nebraska-Lincoln and the United States Department of Agriculture.







ADVENTURE TOGETHER ACROSS NEBRASKA WITH 4-H CAMP

- 
Chadron June 5-9
 Experience Nebraska via horseback, hiking, and with a trip down the Super Slide! Then see the prehistoric Agate Fossil Beds for a week of exploring Nebraska's wilderness, both past and present.
- 
Cozad June 16-20
 Challenge yourself with high ropes, zipline, and a rock wall! Work together with your new friends for a canoeing adventure, and round out your day with gaga and 9 square in the air!
- 
Ashland June 26-29
 Have an "in-tents" outdoor adventure at Mahoney State Park. Cook by the campfire, explore the tree canopy on the ropes course, and make a splash going down the slide at the pool!
- 
Barwell July 16-20
 Explore the flora and fauna with a week on the river front! Explore the North Loup River, go geocaching, tracking, and don't forget about playing an epic game of capture the flag!
- 
Louisville July 27-30
 Close out the summer with an "in-tents" experience at Platte River State Park. Practice your aim at the archery range, investigate the aquatic life at Crawdad Creek, and enjoy s'mores and songs with your new friends!

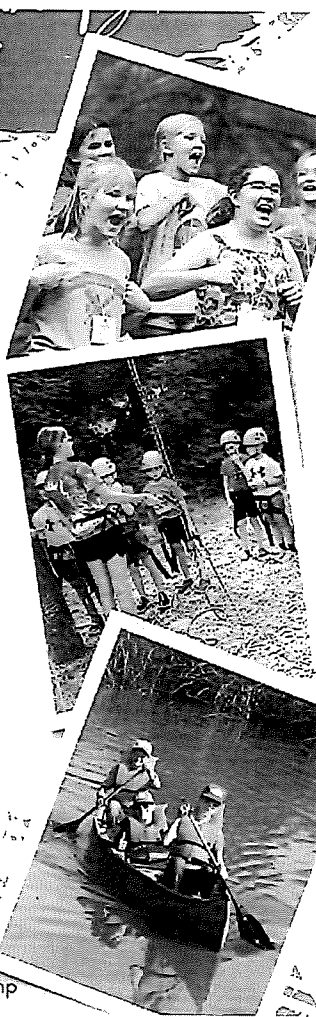

 **Amber Stephens**
 astephens15@unl.edu  4h.unl.edu/camp

Michelle Garwood

Michelle is using Smore to create beautiful newsletters

Created with  **smore**

Communicate quickly and effectively with interactive newsletters.

Smore empowers educators to connect with their community, streamline school communications, and increase engagement.

Create a newsletter

THE CITIZENSHIP DIMENSION IN 4-H

PROGRAM HIGHLIGHTS

The objectives of the workshops and seminars are to:

- ◆ explore the concepts of citizenship
- ◆ practice communication skills
- ◆ increase understanding of global inter-dependence
- ◆ promote awareness of the 4-H extension system as part of the executive branch of government
- ◆ simulate a congressional hearing and review how a bill becomes law
- ◆ increase knowledge of 4-H programs offered throughout America



2025 CITIZENSHIP WASHINGTON FOCUS TRIP

MAY-JUNE 2025

How Do I Sign Up?

Contact

Nebraska Extension - Cherry County
365 N. Main St., Suite 3
Valentine, NE 69201

402-376-1850
800-657-2188

Sponsored by
Nebraska Extension - Cherry County



DESIGNED FOR

All youth that will be age 14-19 when arriving at the 4-H Center in 2025.

WHAT

The Citizenship Washington Focus trip is a living and learning experience in citizenship. Seminars and field trips combine to provide a unique opportunity for using the nation's capital as a classroom. The program supplements the ongoing 4-H citizenship education programs and stimulates youth to search for solutions to contemporary issues, practice leadership skills, and plan for meaningful involvement with 4-H and community programs when they return home. Prior to the trip, participants will attend workshops to learn about all levels of government and other topics to prepare them for the trip.

TOUR SITES

Some of the sites that previous trip participants have seen include: Chicago, Museum of Science and Industry, Sears Tower, Lake Michigan, Professional Baseball Game, Shedd Aquarium, Hershey's Chocolate World, Amish Country, Gettysburg, Niagara Falls, New York City, Radio City Music Hall or a Broadway Play, United Nations, Statue of Liberty, Independence Hall, Liberty Bell, Tomb of the Unknown Soldier, Arlington Cemetery, Mount Vernon, Lincoln Memorial, Capitol, White House, Washington Monument, Vietnam Memorial Monument, National Cathedral, and the Kennedy Center. While in the Washington, D. C. area, participants will stay at the National 4-H Center in Chevy Chase, MD.

ESTIMATED COST

Trips have historically cost approx \$3,000 and includes transportation, lodging, tours, and shows. The price is subject to change depending on inflation and travel expenses. Previous trips have been a bus trip that lasted 12-14 days.

POSSIBLE OPPORTUNITY TO EARN THE COST OF THE TRIP

In past years, Cherry County CWF has formed an organization of potential CWF trip participants and their parents that actively work at money-raising projects over three years under an established set of policy guidelines. Money earned by the participants is held in an account for each individual to help pay the cost of the trip. Previous CWF attendees have earned anywhere from several hundred dollars to the entire cost of the trip. This fund raising aspect of the trip will be available only if several parents are willing to serve on an Executive Board, parents are willing to organize and assume responsibility for the various fund raising activities, and one parent will volunteer to be the Treasurer who is willing to work under UNL and local CWF guidelines to record earnings for each participant, make deposits, pay bills, submit reports, etc. for the entire three year period.

Examples of past fund raising activities have included:

- running concession stands
- participating in individual incentive sales of food items, and evergreen Christmas items



REGISTRATION

To receive information about the trip, fund raising projects, and activities for the CWF trip, fill out the form below, save and e-mail, or USPS mail it to:

CWF

Nebraska Extension-Cherry County
365 N. Main St., Suite 3 Valentine,
NE 69201
cherry-county@unl.edu

or just call 402-376-1850 to register.

Date _____

Name _____

Parent/Guardian Name _____

Address _____

City _____

Telephone (_____) _____

County _____

Birth Date and Year _____

Male or Female _____

School _____

Grade _____

Parent e-mail address _____

Extension is a Division of the Institute of Agriculture and Natural Resources at the University of Nebraska-Lincoln cooperating with the Counties and the United States Department of Agriculture.

The 4-H Youth Development program abides with the nondiscrimination policies of the University of Nebraska-Lincoln and the United States Department of Agriculture.

Niobrara Valley Outdoor Education Partnerships

Nature Fest 2023

Wednesday September 6th @ Fort Niobrara Wildlife Refuge, Valentine, NE

Meet @ Sale Barn grandstands, ¼ mi. past Visitor Center towards Fort Falls trailhead, but turn right before reaching Ft. Falls. Times noted are Central Daylight Time (Note: There will not be a rain date for this event. If there is light rain we will continue as planned, if there is thunder or lightning we will cancel the event for the safety of all involved.)

Agenda

9:30 - 9:45 a.m.	Welcome& Introductions
9:45 – 9:55 a.m.	Presenters travel with groups to their first activity as assigned
9:55 - 10:15 a.m.	Activity
10:15 – 10:20 a.m.	Groups rotate to their 2 nd activity
10:20. – 10:40 a.m.	Activity
10:40 – 10:45 a.m.	Groups rotate to their 3 rd activity
10:45 – 11:05 a.m.	Activity
11: 05 – 11: 10 a.m.	Groups rotate to their 4 th activity
11:10 – 11: 30 a.m.	Activity
11:30 – 11:35 a.m.	Travel to Lunch @ Sale Barn area
11:35 – 12:00 p.m.	LUNCH (bring your own lunches)
12:00 – 12:05 pm	Groups return to the rotation for 5 th activity
12:05 – 12:25 p.m.	Activity
12:25 – 12:30 p.m.	Groups rotate to their 6 th activity
12:30 – 12:50 p.m.	Activity
12:50 – 12:55 p.m.	Groups travel to their 7 th activity
12:55 – 1:15 p.m.	Activity
1:15 – 1:20 p.m.	Groups travel their 8 th activity
1:20 – 1:40 p.m.	Activity
1:40 – 1:45 p.m.	Return to Sale Barn for Wrap-Up
1:45 – 2:00 p.m.	Photo & Farewell
2:00 p.m.	Load Busses/Vans

Teacher Information

The Fort Niobrara Fish and Wildlife Refuge is located on Highway 12 just 4 miles east of Valentine, NE. We will meet at the Sale Barn & corrals approximately ¼ mile beyond the Visitor Center towards the Fort Falls Trail (where the Bison Auction is held.) Bus parking will be on the grass on the right side of the road leading up to the sale barn, along the fence west of the pond. Smaller vans may park by the Sale Barn.

What to bring or wear: Sturdy shoes, Lunch, Water Bottle, Rain Jacket, Nametag, Sunscreen, Hat

- Students should prepare for a full day of being outside by wearing closed toe shoes (sneakers, not flip-flops or sandals) and dressing for the predicted weather conditions. Consider taking some time the day prior to look at the weather prediction and plan with the class. A rain jacket is advised as it can also provide wind protection and some warmth if the day is chilly. Hats or sunscreen can also provide sun protection, as there is little shade in the area.
- It would be very helpful if teachers could provide nametags for their students, so that they may be called upon by name during activities.
- It is expected that teachers, para-professionals and/or parents will participate along with their students to facilitate learning and to appropriately deal with any behavior or classroom management issues.
- Weather: If there is light rain we will continue as planned. However, should thunder or lightning occur we will cancel the event for the safety of all involved. There will not be a rain date scheduled.

This year's presenters include:

Presenter	Organization	Title	Learning Objective
Shawn Jacobs	National Weather Service	Wild & Wacky Weather	How weather works and effects rivers.
Kirsten Dilger	NPS/ACE	Incredible Journey (Water Cycle Game)	Understand earth's water cycle as it applies to Niobrara river
Amber Pearson	Nebraska National Forest	Feather Weather	Understand how birds depend on weather and how it impacts them.
Kate Danziger	NPS	Lightning & Thunder	Understand how lightning and storms form.
Jessica Kinney	NPS	Clouds Over the Niobrara	Cloud formations and what they mean!
Wendy Murphy	Niobrara Council	TBA	TBA
Jack Hilgert	UNL	TBA	TBA
Michelle Garwood	UNL/Cherry County Extension	How Weather Impacts Trees	Understand how weather affects and stresses trees.

From: [Roshone, Bobbie J](#)
To: [Kinney, Jessica M](#); [Danziger, Kate L](#); [Dilger, Kirsten E](#); [Jack Hilgert](#); [Michelle Garwood](#); [Wendy Murphy](#)
[niobraracouncil.org](#); [Pearson, Amber - FS, NE](#); [shawn.jacobs@noaa.gov](#); [Gordon Warrick](#);
[rhammon@rockcountyschools.org](#); [Kristen Krolkowski](#); [jbaker@kpschools.org](#); [becky.lancaster@cody-](#)
[kilgore.com](#); [amorrison@vcsbadger.net](#); [Shiloh Hanzlicek](#); [jfoster@vcsbadger.net](#); [kmkeller@vcsbadger.net](#)
Subject: Thank you all again for Nature Fest
Date: Friday, September 8, 2023 10:03:17 AM

Non-NU Email

Hello all,

I want to thank you all again for making Nature Fest possible! I have the final count of students at 102 and 10 teachers. Here is our group photo!



I really appreciate all that you do as educators both in the classroom and out-- it's always wonderful to bring the two together in such a beautiful place like the Fort Niobrara National Wildlife Refuge.

Thank you,
Bobbie

Bobbie J. Roshone
She/Her/Hers
Park Ranger (I)

Michelle holds a seat on the Valentine Children & Families Coalition Board, representing UNL Extension. UNL Extension had a table at this event with information about joining 4-H and provided give-aways.



Valentine Children & Families Coalition

Apr 19, 2023 • 🌐

Don't forget to mark your calendar for this Friday! Free food, Free ice cream and freebies until they are gone!!

Come Join Us!

EARLY CHILDHOOD DEVELOPMENT AND Childcare EVENT

FREE HOT DOGS/HAMBURGERS & ICE CREAM
FREE TO THE FIRST 100 PEOPLE!!

HOG TROUGH BBQ

SANDHILLS ICE CREAM & TREATS

When: Friday, April 21st, 5-7pm
Where: Cherry County Fairgrounds - Bus Barn

Car seat safety Checks!

Bounce House
Games
Face Painting
Drawings for Family Pool Pass. (Parent must enter)

Lots of FREEBIES

Some have fun with your family & learn about the importance of Early Childhood Development & Quality Childcare.

We Care for Kids

VCFC Valentine Children & Families Coalition

For immediate release: Cherry Co. 4-H Achievement Night Results



Attached Photos:

Achievement Record Books & Project Winners L to R: Wesley Willert (also Top Leaders Award), Tyson Cochran, Case Larson-Talich, Elyse Cochran (also Top Community Service Award), Ava Rahn

Horse Advancement Levels L to R: Katie Schumacher, Kayleigh Harms, Ava Rahn

4-H Project Grant Winners L to R: Matthew Prewitt, Mady Bopp, Christen Larson-Malard, Case Larson-Talich

Town & Country 4-H Club Winners of the James Sexson Memorial Herdsmanship Award Back Row L to R: Club Leader Bodell Bacholor, Annalena Nelson, Sadie Bachelor, Mady Bopp, Keeleigh Burge, Kaden Garwood, Greyson Hollopeter Swan. Front Row L to R: Kyra Garwood, Case Larson-Talich, Kamen Garwood

The annual 4-H Achievement Night was held in Cody on October 15. There was a packed house at the White Elephant Hall for the potluck meal, games, and awards presentations.

Awards presented:

Top 1st Year Achievement Application – Elyse Cochran

Top Jr. Achievement Application – Wesley Willert

(both of these received \$100 scholarships from 4-H Council)

Project Pins

Elyse Cochran – Photography & Citizenship

Case Larson-Talich – Goat & Textiles

Ava Rahn – Horse & Beef

Tyson Cochran – Technology & Food/Nutrition

Wesley Willert – Archery & Citizenship

Top Community Service Award – Elyse Cochran
Top Leadership Award – Wesley Willert

Diamond Clover Awards
Level 1 – Laramie Foster, Elyse Cochran, Tyson Cochran
Levels 1 & 2 – Tilden Foster
Level 5 – Jenalee Garwood

4-H Council Scholarship Winners – Dylan Naslund and Gracey Taylor

Project Grant Winners – Matthew Prewitt, Mady Bopp, Christen Larson-Malard, Case Larson-Talich, and Town & Country 4-H Club

Horse Level Advancement Certificates:
Level 1 – Brekyn Ford, Kayleigh Harms, Ava Rahn, Steklin Robinson, Katie Schumacher

James Sexson Memorial Herdsmanship Award Winners
Independent Family – Ivy & Lillica Jackson
Club – Town & Country

Volume Livestock Sale Buyer
Sandhill Oil

Marathon Kids Race Winners – 5K Jonah Maas, 1 mile Duke Daugherty

Friends of 4-H: Ryan Sexson & Security First Bank

Then all youth who won top County Awards and participated in State and National events were recognized again, and Champion Awards and checks were distributed. If 4-Hers were unable to attend, they can pick up their items at the Extension Office.

4-H Enrollment for 2023-2024 opened October 16 at v2.4honline.com. Contact the Extension Office at 402-376-1850 to learn more about Cherry County 4-H.

2023 Cherry County 4-H Fashion Show & Textile Projects Results

The Cherry County 4-H Clothing Day and Fashion Show was judged on July 13th. The Judges were Celeste Rogers and Pam Bauer. The Fashion Show and Quilts of Valor Ceremony was held August 8 at the Cherry County Fairgrounds.

Top Awards:

Champion Junior Shopping in Style Stylist – Kayleigh Harms (polka dot dress)
Champion Intermediate Shopping in Style Stylist – Brooklyn Coyle (polka dot top)
Champion Senior Shopping in Style Stylist – Kate Cox
Reserve Champion Senior Shopping in Style Stylist – Cadence Swanson
State Fair Shopping in Style Stylist # 1 – Kate Cox
State Fair Shopping in Style Stylist #2 – Kayleigh Harms
Alternate State Fair Shopping in Style Stylist – Brooklyn Coyle
Champion Junior Stylist – Sarah Burge (cheetah print skirt)
Reserve Champion Junior Stylist – Kayleigh Harms (STEAM 1 top/bottom)
Champion Senior Stylist – Grace Brennemann
Reserve Champion Senior Stylist – Ella Brennemann (plaid wool jumper)
State Fair Constructed Garment Stylist #1 – Grace Brennemann
State Fair Constructed Garment Stylist #2 – Ella Brennemann
Alternate State Fair Constructed Garment Stylist – Kate Cox (green romper/white top)
Champion Most Creative Item – Charlene Metcalf (apron)
Reserve Champion Most Creative Item - Katelyn Blackford (doll sleeping bag)
Champion Construction – Grace Brennemann
Reserve Champion Construction – Ella Brennemann (plaid wool jumper)
Champion Junior Quilt – Liam Johnson
Reserve Champion Junior Quilt – Nathan Burchfield
Champion Intermediate Quilt – Brooklyn Coyle
Reserve Champion Intermediate Quilt – Sydnee Dawson
Champion Senior Quilt – Kate Cox
Reserve Champion Senior Quilt – Cadence Swanson
Best of Show Quilt – Ruby Shelbourn
Champion Junior Quilt Design Other Than Fabric - Darby Murphy
Reserve Champion Junior Quilt Design Other Than Fabric – Cameron Wackler
Champion Intermediate Quilt Design Other Than Fabric – Parke Wackler
Reserve Champion Intermediate Quilt Design Other Than Fabric – Brooklyn Coyle
Champion Senior Quilt Design Other Than Fabric – Cadence Swanson

Qualifying for State Fair in Construction:

Quilt Projects: Brooklyn Coyle, Kate Cox, Sydnee Dawson, Cadence Swanson, Liam Johnson, Ruby Shelbourn (All Quilts of Valor).

Shopping in Style - Brooklyn Coyle (4), Cadence Swanson, Kate Cox.

STEAM (Sewing) – Grace Brennemann (red wool coat), Kate Cox (peach top, purple romper), Cadence Swanson (2-piece outfit).

All other results not reflected in Purple Ribbon Top Awards above:

Quilt Quest – Purple, Kase Arganbright (Barn Quilt), Sadie Bachelor (Barn Quilt), Brooke Brashears (Intergenerational Quilt), Will Cox (Quilt of Valor), Wade Daugherty (Barn Quilt), Shyanne Dawson (Quilt of Valor), Syerra Dawson (Barn Quilt), Jenalee Garwood (Two Quilts of Valor), Kyra Garwood (Barn Quilt), Greyson Hollopeter-Swan (Quilt of Valor), Case Larson-Talich (Two Quilts of Valor), Christen Larson – Malard (Two Quilts of Valor), Darby Murphy (Quilt of Valor) Wesley Willert (Quilt of Valor); Blue, Brooke Brashears (Quilt of Valor), Sarah Burge (Barn Quilt), Will Cox (Barn Quilt), Duke Daugherty (Barn Quilt), Kayleigh Harms (Barn Quilt, Quilt of Valor), Darby Murphy (Quilt of Valor).

Fashion Show Modeling - Purple, Katelyn Blackford (STEAM 1 Drawstring Bag), Brooklyn Coyle (Shopping in Style Mix, Match, Multiply & Revive Your Wardrobe), Kate Cox (STEAM 2 white skirt/green top & purple romper), Kayleigh Harms (Beyond the Needle embellished purchased top), Greyson Hollopeter-Swan (STEAM 1 PJ pants), Cadence Swanson (STEAM 2 two-piece outfit, Shopping in Style Best Buy for Your Buck); Blue, Sadie Bachelor (Beyond the Needle Tie Dye Tank & Embellished T-Shirt), Sarah Burge (STEAM 1 lemon pattern skirt), Ella Brennemann (STEAM 2 two-piece outfit), Elyse Cochran (STEAM 1 shorts, Beyond the Needle Tie Dye Shirt), Kayleigh Harms (Shopping in Style Best Buy for your Buck –white shirt/multi-colored skirt), Cadence Swanson (STEAM 2 dress); Red, Sadie Bachelor (Modeled Construction – Bag).

Shopping in Style Construction – Blue, Kayleigh Harms (Shopping in Style Best Buy for Your Buck notebooks – 2); Red, Elyse Cochran (Show Me Your Colors).

STEAM (Sewing) Construction – Purple, Sadie Bachelor (Beyond the Needle tie dye tank), Katelyn Blackford (Beyond the Needle paracord bracelet, STEAM 1 doll dress), Sarah Burge (STEAM 1 lemon print skirt), Ella Brennemann (STEAM 2 two piece outfit), Keeleigh Burge (STEAM 1 simple top), Elyse Cochran (Beyond the Needle tie dye shirt), Kate Cox (STEAM 2 two-piece outfit), Kayleigh Harms (STEAM 1 simple bottom & simple top), Greyson Hollopeter-Swan (STEAM 1 pillowcase & PJ pants), Darby Murphy (STEAM 1 pillow case); Blue, Sadie Bachelor (Beyond the Needle bag & embellished t-shirt), Katelyn Blackford (STEAM 1 pencil bag & drawstring bag), Sarah Burge (STEAM 1 cheetah print skirt), Tyson Cochran (Beyond the Needle tie dye shirt), Kayleigh Harms (Beyond the Needle leather bag & embellished t-shirt), Darby Murphy (STEAM 1 pillowcase), Cadence Swanson (STEAM 2 dress), Elyse Cochran (STEAM 1 simple bottom).



Photo credit: Inspired Imagery by Eve Millar. Back Row L to R: Jenalee Garwood, Shyanne Dawson, Kate Cox, Sydnee Dawson, Ella Brennemann, Grace Brennemann, Christen Larson-Malard. Middle Row L to R: Syerra Dawson, Ruby Shelbourn, Cadence Swanson, Brooklyn Coyle, Will Cox, Brooke Brashears, Wesley Willert. Front Row L to R: Darby Murphy, Nathan Burchfield, Liam Johnson, Kayleigh Harms, Sarah Burge, Adley Swanson, Cam Brashears, Case Larson.



Twenty-five Quilts of Valor were awarded to Veterans during the 2023 Cherry Co. Fair, bringing the total amount awarded by Cherry County residents to over 100! Several of these special heroes were in attendance at the ceremony, some traveling from as far as Florida! Back row L to R: David Weinmaster, Kenneth "Buddy" Bolzer, Chet McCormick, Michael R. Young, William Kluender, Layne Jose, Kathy Perrett, Chad Schneider, Jim Murphy, Forrest Eberly. Middle row L to R: Eldon Eugene (Gene) Bolli, Mike Hronek, Tim Wrage, Wade Shipman, Larry Holmes, Carol Shepler, Joan Potter, Kelly Keogh, DeWayne Lancaster, Brian Magiera, Gary Eberly. Youth middle row L to R: Jenalee Garwood, Shyanne

Dawson, Cadence Swanson, Ruby Shelbourn, Brooke Brashears, Brooklyn Coyle, Wesley Willert. Front row L to R: Sydnee Dawson, Liam Johnson, Nathan Burchfield, Adley Swanson, Case Larson-Talich, Cam Brashears, Kayleigh Harms, Kate Cox, Will Cox, Darby Murphy, Christen Larson-Malard.

Quilts Awarded:

Will Cox to Carol Shepler, Kate Cox to William Kluender, Ruby Shelbourn to Michael R. Young
Brooke Brashears to John Helm II, Cam Brashears to Wade Shipman, Darby Murphy to Jim Murphy and Joan Potter, Kayleigh Harms to Darrel Atchison, Wesley Willert to Brian Magiera, Sydnee Dawson to David Weinmaster, Shyanne Dawson to Kenneth "Buddy" Bolzer, Jenalee Garwood to Dale Garwood and Mike Hronek, Cadence Swanson to Tim Wrage, Adley Swanson to Eldon Eugene (Gene) Bolli, Brooklyn Coyle to DeWayne Lancaster, Greyson Hollopeter-Swan to Chet McCormick, Christen Larson-Malard to Kelly Keogh and Layne Jose, Case Larson-Talich to Larry Holmes and Kathy Perrett, Liam Johnson to Gary Eberly, Nathan Burchfield to Forrest Eberly, Rhonda Cherry to Chad Schneider and Robert Treat.

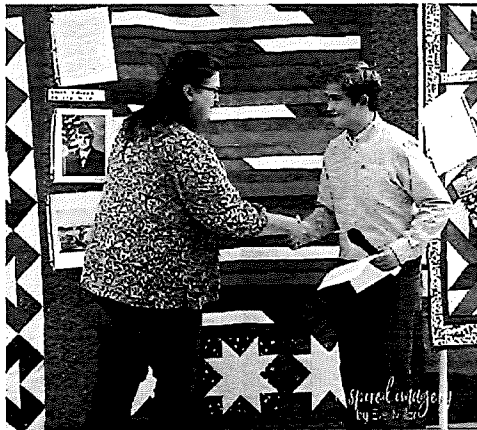

4-H members interview the Veteran recipients and share their stories as part of the annual Quilts of Valor presentation ceremony at the Cherry County Fair. Will Cox thanks Carol Shepler for her service.

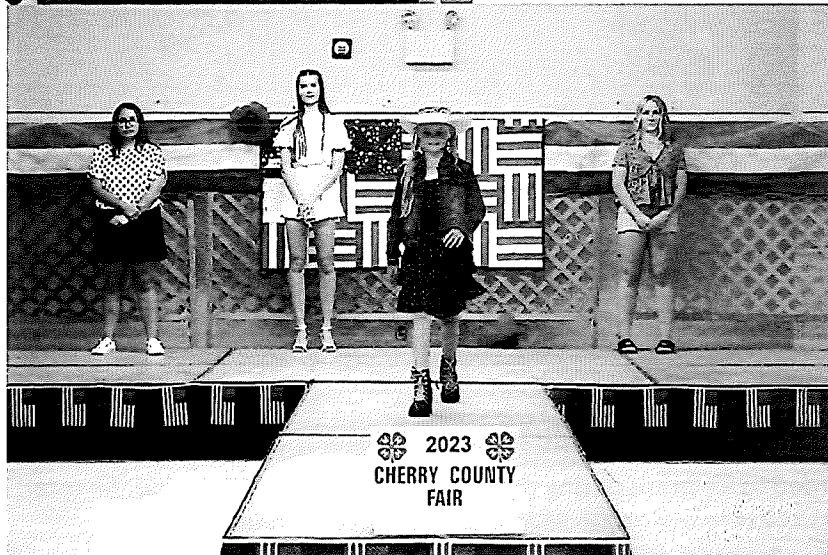

L to R: Brooklyn Coyle, Kate Cox, Kayleigh Harms, and Cadence Swanson take turns modeling their Shopping in Style outfits at the 2023 4-H Fashion Show.

For immediate release: Cherry Co 4-H Badger Bots Award Winners at State Robotics Competition!

The Cherry County 4-H Badger Bots Robotics team traveled to Columbus, NE this weekend to compete in the Nebraska State 4-H First Lego League Robotics Competition. It was the first year they received a trophy at the State competition in their three years competing there. They walked away with 2nd place in the Innovation Project with their presentation about a geothermal cattle tank. Forty teams advanced from the original 97 teams that competed in Regional qualifiers held earlier this year. Badger Bot team members included: Isaac Utecht, RJ Dean, Tyler Harp, Duncan Mosner, Tilden Foster, Kaden Garwood, Allen Ward and Cole Boes. They were coached by Andrew Utecht and James Ward with Michelle Garwood, 4-H Educator, serving as team manager. If you want to learn more about 4-H Robotics, contact Michelle at 402-376-1850 or mgarwood3@unl.edu.

Attached photo: Back row, L to R: Tyler Harp, Isaac Utecht, Duncan Mosner. Front row, L to R: Allen Ward, Kaden Garwood, Cole Boes, Tilden Foster, RJ Dean

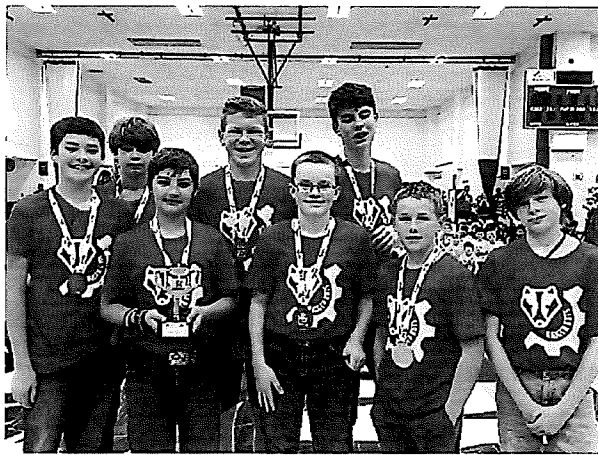

For immediate release: Cherry County Robotics teams compete at regionals, Badger Bots qualify for State!

Attached photos

Cherry Co Bots

Back Row L to R: Cody Kilgore School Mentor, Ashley Kasner and Coach Michelle Garwood.

Front Row L to R: Krosston Kasner, Will Cox, Jaeden Garwood



Badger Bots

Back Row L to R: Coaches James Ward and Andrew Utecht

Middle Row L to R: Isaac Utecht, Duncan Mosner, Kaden Garwood, Allen Ward, Cole Boes

Front Row L to R: RJ Dean, Tilden Foster, Tyler Harp



On February 4, Cherry County 4-H had two teams competing at the Nebraska 4-H First Lego League Robotics Regional Qualifier in Henderson, NE. The Badger Bot Team qualified for the State Competition for the third year in a row with mostly all returning members: RJ Dean, Duncan Mosner, Isaac Utecht, Allen Ward, Tyler Harp, Cole Boes, Kaden Garwood and Tilden Foster. The Badger Bots received 2nd place in the Innovation Presentation portion of the competition with their idea for a geothermal cattle tank. They are coached by Andrew Utecht and James Ward. They will compete at the State Competition on February 18 in Columbus, NE.

Cherry County also expanded this year for the first time and had a second team competing. The Cherry County Bots team consisted of Will Cox, Jaeden Garwood and Krosston Kasner. For more information about Robotics or 4-H, please contact Michelle Garwood, Cherry Co. 4-H Educator, at 402-376-1850.

For immediate release: Naslund Competes at National 4-H Shooting Sports Championships

Dylan Naslund, son of Adam and Janell Naslund of Cody, NE, represented Nebraska 4-H at the National 4-H Shooting Sports Championships held in late June. He was a member of the compound archery team which placed 6th overall. Each year the competition is held in Grand Island, NE. This is the second year that Dylan has qualified for the national team. To learn more about 4-H shooting sports program, contact the Extension Office at 402-376-1850.

(Attached photo, Dylan is on the far right.)



AMY TIMMERMAN

Extension Educator – Crops & Water

Accountability Region – Boyd, Brown, Cherry, Holt, Keya Paha & Rock

2023 Annual Report

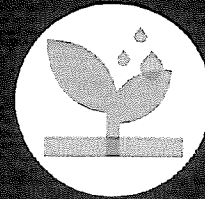

N Field Observation

Social media has become an integral part of our daily lives by providing real-time information. Nebraska agricultural producers are using social media avenues to learn about issues they are encountering and learning from each other which ultimately leads to operational decisions being made. Research has shown that the average adult has an attention span of about 10 minutes when listening to a lecture and 47 seconds when working on a screen. However, a study has found that the average human attention span is eight seconds. To meet these new challenges of reaching clientele in Nebraska and further, I lead a team of eight Extension Specialists and Educators to revive N Field Observations.

N Field Observations was originally established in 2020 because of COVID and continued through part of 2021 and was shared via Twitter through each contributor's account. The program stopped in 2021 due to the program leader leaving Nebraska Extension. For the revival in 2023, N Field Observations was created with its own stand-alone social media account on Twitter (X) but also expanding to Instagram, Facebook, YouTube and TikTok, with the goal to release a minimum of one video post per week. To counteract the short attention span of clientele, videos are edited to two minutes 19 seconds with link to the YouTube channel for longer content. The goal is addressing real-time issues being experienced such as natural disasters and pest outbreaks. They also provide an opportunity to provide tips and insights related to agriculture production, showcase new strategies, and updates on field research. The following are the roles that I served for this project: 1) Team Leader; 2) Created a Microsoft Team Account where all how-to, videos and information are uploaded/shared; 3) Manage and coordinate all video editing; 4) Review all video content prior to posting; 5) Content creator; and 6) Evaluation.

N Field Observation Impacts

- Total of 37 videos were edited and posted from April-November
- I created content for 16 videos (43% of all videos)
- An average of 1,213 views/impressions via X per video post
- Evaluation was created and shared via X. However, only received one response.

Negative Impact of Nitrate & Mitigating Water Quality Issues

In 2023, I was working on reducing my time and efforts to the Bazile Groundwater Management Area Team (BGMA). However, with the departure of Jeremy Milander on July 1st, I have been re-engaging with the group and serving as the local liaison between UNL and BGMA. The goal of this team is to provide education about the negative impact of nitrate but also ways to mitigate high groundwater nitrate levels in the area. I regularly attend monthly BGMA steering committee meetings. I have also been involved in planning meetings between the four NRD managers and UNL administration on plans to replace the BGMA educator position.

The Nebraska Environmental Trust grant that funded the demonstration plots concluded in 2022. I coordinated the UNL demonstration plot team in compiling and presenting their research data to all the BGMA partners. Beyond the partners, all data was present to each of the 4 NRD Board of Directors. Of those Board of Director Meetings, I presented all data at Upper Elkhorn NRD and Lower Niobrara NRD. This interaction increased the transparency of the research being conducted but also provided opportunity for in-depth conversations regarding the meaning of the results and next steps to be explored.

Long-term evaluation of attendees of BGMA field days and winter meetings for 2020-2023 will be conducted the winter of 2024 to assess long-term behavior and attitude changes.

I was invited to be a presenter at the Upper Elkhorn NRD nitrogen certification training which is a required training every producer who applies more than 50 lbs of nitrogen. My presentation was the hands-on Nitrogen calculator program developed by Aaron Nygren. A total of 202 producers participated in the program.

Nitrogen Certification Impacts

- 63.5% (n=200) have no system to remove nitrate in their private well
- Average rating of 3.15 (n=201) of concerns of nitrates in drinking water with 1 being no concerned and 5 being very concerned)
- 89% (n=201) believe the UNL Algorithm is an effective tool for estimating N needs
- "The talking and explaining different things on nitrogen management is on point. My son said on the way home he learned a lot today and it's his 2nd time to renew. Always a good thing to keep everyone fresh on the knowledge. Great job" Producer Participant

Cropping Systems

I maintain a strong relationship with the extension faculty in the Department of Plant Pathology and am serving as an affiliate member. Through this relationship, I served as a contributing author for the potato section of the 2024 Guide for Weed, Disease and Insect Management in Nebraska. Also, it allows me to stay up to date on new emerging pests and in particular fungicide resistance development in Nebraska, but throughout the U.S. I use the knowledge gained from this relationship to present current topics at

Crop Production Clinic Impacts – Traditional

- Directly taught 275 learners
- 70% Have increased knowledge of crop management.
- 68% Have increased knowledge of disease management.
- Use more than one mode of action to control the same pest – change as result of program.

Crop Production Clinics (CPC) by presenting "Corn Disease Update" and "Soybean Disease Update" at two locations.

I was team member to assist Chris Proctor to develop and deliver a program aimed to

increase adult learner engagement through several hands-on activities. My roles included: 1) Redesigning the pesticide mixing and incompatibility exercise for a large group; 2) Provide input for evaluation questions and 3) Teaching at both locations, this option was offered.

Crop Production Clinics Impacts – Adult Learner Focused

- Directly taught 194 learners
- 69% Have increased the understanding of the importance of product mix order and compatibility.
- \$9.4 value of knowledge gained per acre.
- Incorporating the use of 12 mil gloves to change nozzle bodies – change of results of program.
- "Best private Pest training I have been to by fair – actually learn something – not a wasted day."

Other Contributions

- I serve as the education coordinator for weather ready farms. In 2023, I served as a Co-PI with 27 fellow UNL faculty to submit a 2.9 million UNL Grand Challenges Grant Proposal which was not successful in receiving funding. However, being a Co-PI I was active in the development and editing of the proposal.
- Approximately 1 million indirect contacts from 28 radio spots based out of Valentine and O'Neill reaching clientele in Nebraska and South Dakota.
- I submit a minimum of one newspaper article per week that is submitted to six newspapers in the area.

Unit Leader

- Successfully hired a full-time office manager after it being vacant July 2022-March 2023 and after 4 failed position searches.
- I was responsible for county and state financials (Jan-Mar).
- Assisted in coordinating the interview for the new Livestock System Educator housed in Holt County. My responsibility was ordering the meal, inviting the extension board, and local stakeholders, and giving candidates a tour of the Holt County Extension Office.
- Successfully received county budget approval to increase salary for Boyd County full-time office manager, Holt County full-time office manager and Holt County part-time office manager by 7%, 5% and 9% respectively.
- Approval of Memorandum of Agreement, Extension Board Constitution & By-laws by Holt and Boyd Extension Boards and Board of Supervisors.
- Extension Board activities include all board meetings, meeting agendas, on-boarding new members and inviting regional educators to meetings (Steve Neimeyer & Jordan Rasmussen).
- Attended 5 Boyd County Supervisor Meetings (meet once a month) and 4 Holt County Supervisor Meetings (meet twice a month).

Service

- Nebraska Cooperative Extension Association & Ag Section Member
- American Phytopathological Society & North Central Region Member
- Master Graduate Student Committee Member – University of Kansas
- Zone 2 Faculty Senate Representative
- EDEN member representing Zone 2
- Affiliate Faculty Member in the Dep. of Plant Pathology
- Diversity, Equity, and Inclusion Committee Member in the Dept. of Plant Pathology
- SET Superintendent for Nebraska 4-H State Fair

Professional Development

- Water for Food Conference
- Agricultural Threat Symposium
- North Central American Phytopathological Society Meeting
- Emotional Intelligence
- CPR & 1st Aid
- CAPacity Building Webinar
- Department of Plant Pathology Seminar Series

N Field Observations

Public Value

Nebraska Extension is passionately dedicated to advancing proactive and reactive, research-based, practical solutions to challenges faced by Nebraskans. Our objective is to rely on our understanding of cropping systems, soil health, integrated pest management, farm management, integration of livestock in cropping systems, and water quality & quantity.

The Situation

Social media videos have become an integral part of our daily lives. They provide us with real-time information and keep us updated on the latest trends and news. The beauty of social media videos is that they are relevant to our interests and needs and allow us to stay connected with the world around us. It is leading agricultural clientele to use these avenues to learn about issues they are encountering and learning from each other which ultimately leads to operational decisions being made.

Extension Response

A team of Extension Educators and Specialists create weekly videos to share on social media platforms like Facebook, Twitter, Instagram and TikTok titled "N Field Observations." These videos are designed to be relevant and engage clientele that is both informative and relatable. We can address real-time issues that are being experienced such as natural disasters and pest outbreaks. Also, able to provide tips and insights related to agriculture production, showcase new strategies, and share updates on field research.

Impacts

From April through November, N Field Observations created and posted 37 videos. Videos were created by a team of 8 Extension Specialists and Educators. X (formerly Twitter) is the primary social media platform used with posts being reshared locally,

regionally, and internationally. N Field Observation videos are being viewed an average of 1,213 times each week.

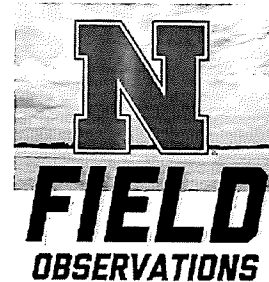

Participants Feedback

"I appreciate the timely educational videos. There is a lot of valuable information shared in a short amount of time." Social media viewer

Primary Contact

Amy Timmerman

Extension Educator

402.336.2760; atimmerman2@unl.edu

Twitter: @NFieldObs & @AmyTimmerman2

Collaborators

Amit Jhala - Extension Weed Specialist, Tamra Jackson-Ziem - Extension Plant Pathology Specialist, Dylan Mangel - Extension Plant Pathology Specialist, Julie Peterson - Extension Entomology Specialist, Chuck Burr - Extension Educator, Steve Melvin - Extension Educator, and John Thomas - Extension Educator

Extension Big 3 Alignment

- ☒ Strengthen Nebraska Agriculture & Food Systems
- ☐ Inspire Nebraskans & Their Communities
- ☐ Enhance The Health & Wellbeing of All Nebraskans

2023 Impact Statement – David Lott, Extension Educator, HLES

Beginning Latino Gardening Program Series – DEI/New Audience Outreach

I built a partnership with the West Central Health District to teach a series of five hands-on beginning gardening lessons to 23 low-income and high-risk Latinos and one Ukrainian in North Platte this spring. These bilingual classes were taught with Sandra Barrera Fuentes on how to grow herbs and vegetables at their homes to increase fresh food access and reduce their food costs. Brenda Aufdenkamp taught how to cook with the produce, reducing sodium use in food preparation or seasoning. Post class evaluation impacts are statistically significant where $p < .01$:

1. "I am confident that I can grow and maintain a container garden."
2. "I am confident that I can grow indoor container herb gardens to save money and better quality."
3. "I will make at least one new dish using fresh vegetables and herbs reducing salt use."

Disability Transition Student Gardening Life Skills Series - DEI Outreach

This is my second year of diversity, equity and inclusion programming with Education Service Unit 16 and North Platte Public Schools with 18 transition cognitive disabled students to learn life skills according to Nebraska education standards. These students come to work in the greenhouse twice a week in 29, two-hour sessions to learn about plants, environmental science, and working with others. Weekly activities help strengthen fine and gross motor skills along with problem solving skills. Student conducted a sale of the they plants they grew on May 3rd at the WCREEC greenhouse. The sale raised \$2,000 to be a self-sustaining program for future years. Developmentally appropriately student surveys produced the following impacts where $p < .01$:

1. "I learned how to plant grow plants."
2. "I learned how to water and care for plants."
3. "I helped others and sell plants."

This is the second year of this program, and evaluations show that I have now reached a total of 36 students with highly statistically significant outcomes on the following evaluation questions where $p < .01$ of the above evaluation impacts.

Gardening In Weather Extremes Series – Responsive Programming

To address increased climate variability and landscape stress, I conducted a series of five roundtable program updates to 42 people in my region on landscape and garden management strategies to reduce plant stress and increase environmental sustainability. Post growing season evaluations produced the following practice changes where $p < .01$:

1. "I have used two new ways to reduce pesticide use in the landscape."
2. "I will select plant material that fits the environment and growing conditions."
3. "I have used two or more new ways to conserve water and reduce weed pressure."

Program Testimonial: *"By raising the mower height at work by one inch, we do not have to water or mow as often over seven acres of school property!"*

Accountability Region Horticulture Outreach – Established Programming

Answering horticulture calls, email, social media messages and personal visits in my Accountability Region and beyond, I am serving the Extension Offices in my region to answer questions and help customers. I completed **803 emails, calls, and visits** across the region and Nebraska by December 1, 2023. This service connects customers with research-based information in a rural region where there are few horticulture businesses and resources. Building these connections with quality recommendations, customers in my region know that they can contact their local Extension Offices, they will receive a quick reply for help. I also share news column stories, press releases and social media posts with these offices to utilize in program promotion at the local level once a week for most of the year. I have also started writing these materials in Spanish last fall go to the accountability and Spanish media outlets.

Social media is difficult to quantify impact, but it does expand my horticulture information outreach out into public and social media world. My **Nebraska Gardener Facebook** page reaches **2788 individuals that they share with others at least once a week**. My largest audiences are adults aged 35-44, a generation of adults that are not as familiar with Extension as previous, older generations. **On a national level, research has shown that this generation is also an emerging audience that is investing time in landscaping and gardening for the first time.** This is an encouraging outcome of this effort.

I plan to set quick polls on my social media posts throughout the year to track what people are learning and gather feedback to track practice change and demographics from the material that they learned throughout the year to improve quantifying impact of my social media efforts throughout the year.

Program Evaluation HLES Team – Statewide Leadership

I have learned how to write evaluation questions for post class and post growing season data collection on Likert scales to conduct Pearson Square analysis and find statistical significance on participant learning and practice change. I am the HLES evaluation lead for the **ProHort and Gardening for Market statewide programs to improve evaluation and impact documentation.**

Extension Master Gardener Program

Sixteen Master Gardeners from six counties completed **1,509 volunteer and education hours valued at \$45,194.55** back to their communities sharing correct horticulture information and helping in educational programs.

One major program was the Deborah's Legacy Garden Tour in North Platte June where **195 visitors toured the garden and visited with the Master Gardener at the WCREEC** on their demonstrations on hay bale gardens, drip irrigation, container gardens, floating row covers, trash can garden composting bins and vertical gardening. Evaluation data show that learners learned water conserving, space saving and pesticide reduction techniques at a statistically highly significant level where $p < .01$.

Other Accomplishments

Tough As Nails Plant Sale – Revenue Generation

One major effort by the Master Gardeners was to create a plant sale of low water use perennial plants that improve pollinator habitats in landscapes by anyone who purchases and raises them. The plant sale in May yielded a net profit of \$3,400 to help sustain the Master Gardener program's activities.

HLES Team Leadership – Leadership

I served in several leadership roles in the HLES teams as part of the online Master Gardener training series to plan the 2023 program, **Co-Lead of the team's Husker Harvest Day** educational display and teaching at the event, the evaluation and analysis lead of the ProHort program, and helped design the **HLES program base evaluation tool** to consolidate evaluation data over all HLES programs going forward on the PEARS system.

UNL Faculty Senate and Senate Executive Committee – Leadership

I was very engaged during 2023 as a UNL Faculty Senator and a member of the Executive Committee. I attended weekly meetings in this role to discuss student recruitment, graduate student supervision, campus safety, academic freedom, green card sponsorship for new hires, campus enrollment and budget cuts. As an Extension representative to the Executive Committee, I gave the outstate perspective to these issues and how Extension can provide input and perspective on these issues. After meetings conclude, I would share information that would impact Extension faculty and staff back out to the system.

NCEA Leadership – Leadership

In August, I was **elected President Elect** of the Nebraska Cooperative Extension Association to fill the vacancy left by Randy Saner. In this role, I became a member of the NCEA Ad Hoc Committee to coordinate conference details and the budget. **Through my leadership, the conference did not lose money as it was going to before my leadership started.** I also compiled the large multi committee NCEA Annual Report of all activities from the officers and committees. I was sworn in as **NCEA President at the NCEA Conference in November.**

Lead Educator Roles – Leadership

With the change of leadership in the Lincoln-Logan-McPherson County Office, I became in charge of working with the Extension Board this fall. Later in December, I carried out staffing related assignments to help improve office communication and accountability.

Educator Mentoring - Leadership

Through 2023, I have served as a mentor to other educators to review children's book manuscripts for Julie Boyle, evaluation, and presentation advice to Nicole Stone for the NACAA Conference, to Caitlyn Jacobson on 4-H management at her request, and to Randy Saner on building a base evaluation tool for the Livestock Team.

Beginning Latino Vegetable Gardening

Public Value

Access to fresh vegetables was greatly disrupted in the COVID-19 pandemic with a breakdown in food distribution supply chain regardless of ethnic background and income levels. In response, 16 million individuals started vegetable gardening in 2020 with little or no experience or expertise.

The Situation

Low-income at-risk families are negatively impacted by food access and food security, especially during the pandemic. To help this audience become more self-sufficient, I have teamed up with the West Central Health Department, Brenda Aufdenkamp, FNH Educator and Sandra Barrera Fuentes, RPN Educator to create a series of five classes for Latino families in North Platte on how to learn how to grow, cook, and reduce sodium intake on the vegetables and herbs they grew in the classes. These classes were translated into Spanish and Ukrainian.

Extension Response

Sandra, Brenda, and I met with Maria Lein to plan a series of hands-on herb and vegetable gardening lessons where participants learn how to plant crops from seeds, container vegetable gardening tips, harvesting, storing, drying and cooking with herbs and vegetable crops chose by the participants. 23 Latinos and 1 Ukrainian attended a series of five, two-hour lessons.

Post class evaluation impacts are statistically significant where $p < .01$:

"I am confident that I can grow and maintain a container garden."

"I am confident that I can grow indoor container herb gardens to save money and better quality."

"I will make at least one new dish using fresh vegetables and herbs reducing salt use."



Program Testimonials

"I can grow herbs that I cannot find at the store!"

"I don't have to dig a garden. I can garden in a bucket."

"I will make some new recipes from class!"

Sandra and I were invited to present at the 2023 International Master Gardener Conference on teaching people from different cultures!

Primary Contact

David Lott, Horticulture Educator

348 W. State Farm Road

North Platte, Nebraska 69101

(308) 532-2683 – dlott2@unl.edu

Collaborators

Maria Lein, WC Health Department

Tina Maria Fernandez, Hope Esperenza

Sandra Barrera Fuentes, RPN Educator

Brenda Aufdenkamp, FNH Educator

Extension Big 3 Alignment

X Strengthen Nebraska Agriculture & Food Systems

X Inspire Nebraskans & Their Communities

X Enhance The Health & Wellbeing of All Nebraskans